

# HARDROCK®

## UB34

Non-combustible insulation solution  
for upstands and parapet walls

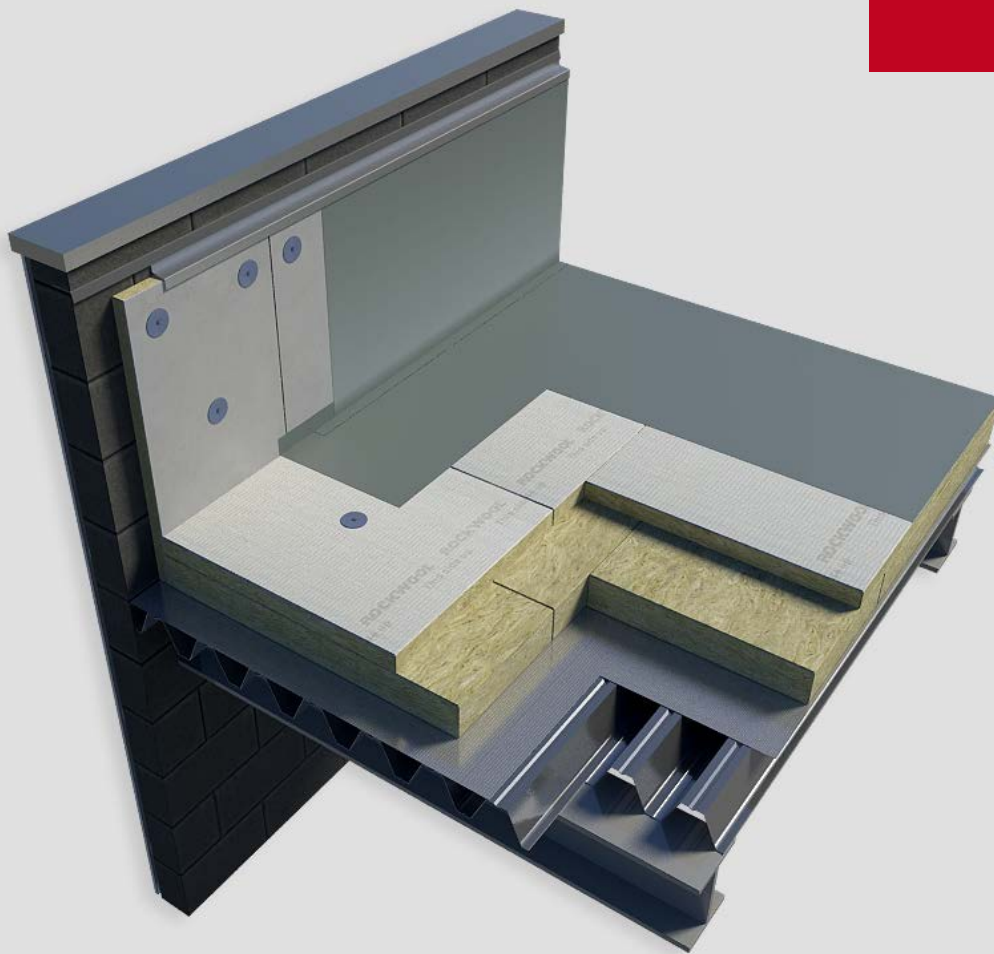

## HARDROCK® UB34

Non-combustible insulation solution for upstands and parapet walls.

Consisting of a dense ROCKWOOL insulation slab bonded to a rigid 6mm exterior-grade fibre cement board, this non-combustible product provides an impact and weather-resistant insulation solution for flat roof upstands and parapet walls.

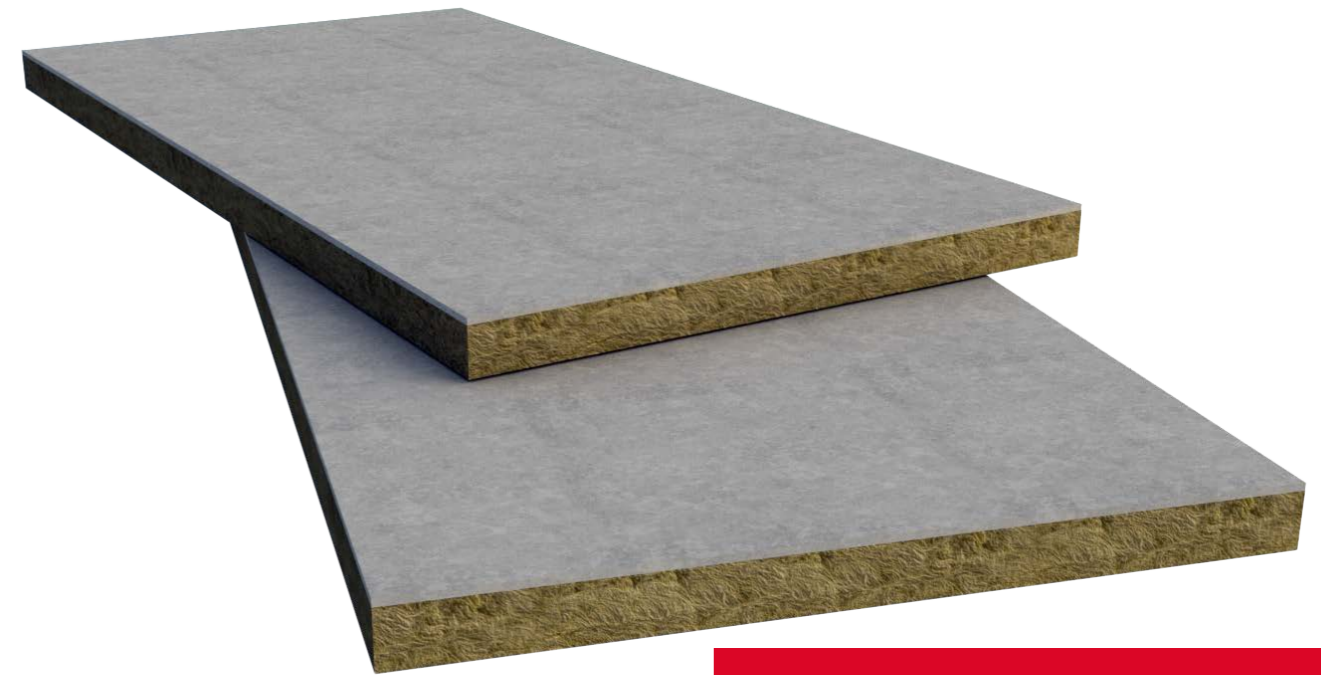

### Advantages

- Euroclass A2-s1,d0 (non-combustible)
- Low thermal conductivity at 0.034 W/mK
- Impact and weather resistant
- Easy to handle on site
- Compatible with a variety of roof systems

### Description

ROCKWOOL insulation bonded to an exterior-grade fibre cement board, forming a non-combustible solution for insulating upstands and parapet walls.

### Applications

Compatible with a variety of roof systems.

## Technical information

### Dimensions

Property	Description
Length	1200mm
Width	600mm
Thickness	56mm (50mm insulation, 6mm cement fibre board)

### Thermal

Thermal conductivity: 0.034 W/mK

### Fire

Euroclass A2-s1,d0 (non-combustible)

### Installation Instructions

Installation will vary depending on the roof system being installed. For specific guidance please refer to the relevant waterproofing manufacturer.

At a minimum we recommend there is always at least one centrally located insulation fixing per board.

When installed, provided that the top surface is protected by a sill or cover, HARDROCK® UB34 is suitable for long term exposure - for example when used in conjunction with an inverted roof system.

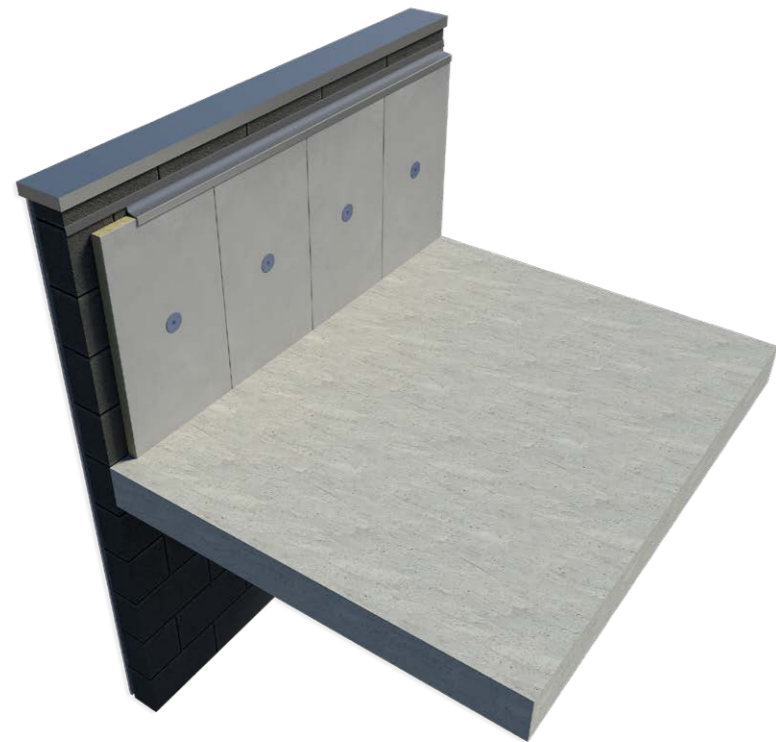

## Notes

## Sustainability

As an environmentally conscious company, ROCKWOOL promotes the sustainable production and use of insulation and is committed to a continuous process of environmental improvement.

All ROCKWOOL products provide outstanding thermal protection as well as four added benefits:



**Fire resistance**



**Acoustic comfort**



**Sustainable materials**



**Durability**

## Health & Safety

The safety of ROCKWOOL stone wool is confirmed by current UK and Republic of Ireland health & safety regulations and EU directive 97/69/EC: ROCKWOOL fibres are not classified as a possible human carcinogen.

A Material Safety Data Sheet is available and can be downloaded from [www.rockwool.co.uk](http://www.rockwool.co.uk) to assist in the preparation of risk assessments, as required by the Control of Substances Hazardous to Health Regulations (COSHH).

## Environment

Made from a renewable and plentiful naturally occurring resource, ROCKWOOL insulation saves fuel costs and energy in use and relies on trapped air for its thermal properties.

ROCKWOOL insulation does not contain (and has never contained) gases that have ozone depletion potential (ODP) or global warming potential (GWP).

ROCKWOOL is approximately 97% recyclable. For waste ROCKWOOL material that may be generated during installation or at end of life, we are happy to discuss the individual requirements of contractors and users considering returning these materials to our factory for recycling.



## The ROCKWOOL Trademark

ROCKWOOL® - our trademark

The ROCKWOOL trademark was initially registered in Denmark as a logo mark back in 1936. In 1937, it was accompanied with a word mark registration; a registration which is now extended to more than 60 countries around the world.

The ROCKWOOL trademark is one of the largest assets in the ROCKWOOL Group, and thus well protected and defended by us throughout the world.

If you require permission to use the ROCKWOOL logo for your business, advertising or promotion. You must apply for a Trade Mark Usage Agreement. To apply, write to: [marketcom@rockwool.com](mailto:marketcom@rockwool.com).

## Trademarks

The following are registered trademarks of the ROCKWOOL Group:

ROCKWOOL®  
 ROCKCLOSE®  
 RAINSCREEN DUO SLAB®  
 HARDROCK®  
 ROCKFLOOR®  
 FLEXI®  
 BEAMCLAD®  
 FIREPRO®

## Disclaimer

ROCKWOOL Limited reserves the right to alter or amend the specification of products without notice as our policy is one of constant improvement. The information contained in this brochure is believed to be correct at the date of publication. Whilst ROCKWOOL will endeavour to keep its publications up to date, readers will appreciate that between publications there may be pertinent changes in the law, or other developments affecting the accuracy of the information contained in this brochure. The applications referred to within the brochure do not necessarily represent an exhaustive list of applications. ROCKWOOL Limited does not accept responsibility for the consequences of using ROCKWOOL in applications different from those described within this brochure. Expert advice should be sought where such different applications are contemplated, or where the extent of any listed application is in doubt.

© ROCKWOOL 2018. All rights reserved.

## Photography and Illustrations

The product illustrations are the property of ROCKWOOL Ltd and have been created for indicative purposes only.

Unless indicated below, the photography and illustrations used in this guide are the property of ROCKWOOL Limited. We reserve all rights to the usage of these images.

If you require permission to use ROCKWOOL images, you must apply for a Usage Agreement. To apply, write to: [marketcom@rockwool.com](mailto:marketcom@rockwool.com).

## Interested?

For further information, contact the Technical Solutions Team on 01656 868490 or email [technical.solutions@rockwool.co.uk](mailto:technical.solutions@rockwool.co.uk)

Visit [www.rockwool.co.uk](http://www.rockwool.co.uk) to view our complete range of products and services.

Copyright ROCKWOOL September 2018.

June 2021

**ROCKWOOL Limited**

Pencoed  
Bridgend  
CF35 6NY

Tel: 01656 862 621

[info@rockwool.co.uk](mailto:info@rockwool.co.uk)

[rockwool.com/uk](http://rockwool.com/uk)



Version 2.00 June 2021

© ROCKWOOL 2021. All rights reserved.