

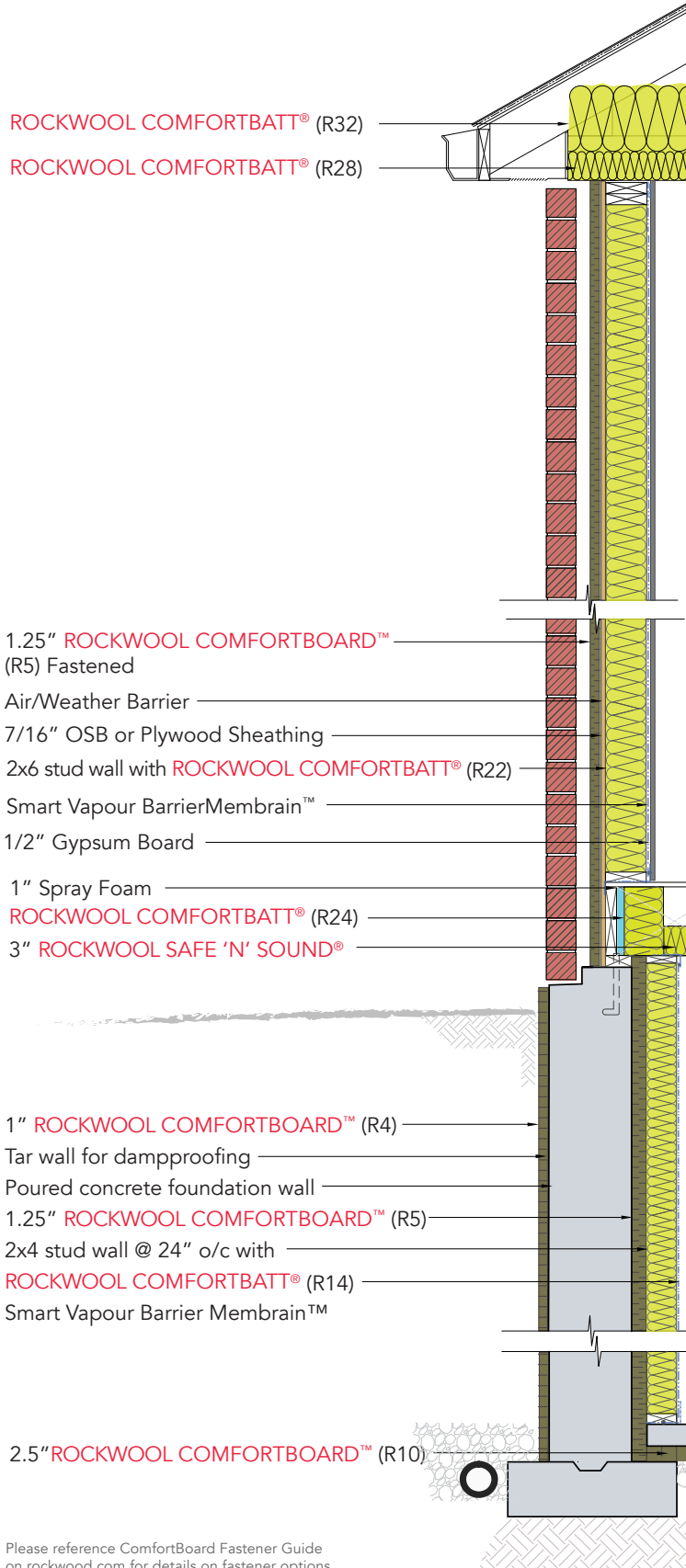

ROCKWOOL Solutions for Ontario Building Code

January 1st 2017





Please reference ComfortBoard Fastener Guide on rockwool.com for details on fastener options.

What is Continuous Insulation? It is an uninterrupted layer of insulation on the exterior of the structure, and in some case the interior. With the exception of services and fasteners there are no thermal breaks in this layer. This greatly reduces the amount of heat transfer or "thermal bridging" through the wall assembly.

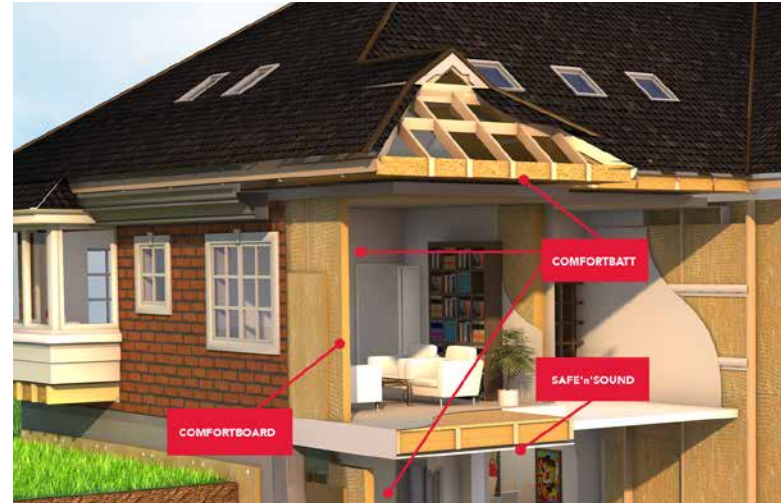

Changes to Ontario Building Code (Supplementary Bulletin SB-12), became effective January 1 2017, codes are moving to increase thermals to improve the overall energy efficiency of our homes. There are numerous ways to achieve these new thermal values and many now include the use of Continuous Insulation (ci).



ROCKWOOL manufactures a high performance non-structural insulated sheathing called COMFORTBOARD™. This product is your solution for meeting or exceeding the ongoing code changes. COMFORTBOARD offers many unique features such as superior fire resistance, water repellence, sound dampening and it is stable in composition in extreme heat and cold conditions. As well, COMFORTBOARD's vapour permeability will let trapped moisture inside a structure escape allowing the envelope to stay dry and free of mold or rot. COMFORTBOARD's unique set of characteristics set it apart from other Continuous Insulation options, giving your wall assembly the durability, thermal value and resiliency it needs with today's changing code requirements.

Above Grade Wall

MMAH Supplementary Standard SB-12 - Table 3.1.1.2.1 (IP)

ZONE 1 Compliance Packages for Space Heating Equipment with AFUE > 92%						
	A1	A2	A3 (2X4)	A4	A5	A6
Minimum Nominal R (ci=continuous insulation)	22	19+5ci	14+7.5ci	22+5ci	19+5ci	22+5ci
	Use R22 COMFORTBATT	Use 1.25" COMFORTBOARD R5 and R22 COMFORTBATT	Use 2" COMFORTBOARD R8 and R14 COMFORTBATT	Use 1.25" COMFORTBOARD R5 and R22 COMFORTBATT	Use 1.25" COMFORTBOARD R5 and R22 COMFORTBATT	Use 1.25" COMFORTBOARD R5 and R22 COMFORTBATT

ZONE 2 Compliance Packages for Space Heating Equipment with AFUE > 92%						
	A1	A2	A3 (2X4)	A4	A5	A6
Minimum Nominal R (ci=continuous insulation)	22	19+5ci	14+7.5ci	22+5ci	19+5ci	22+5ci
	Use R22 COMFORTBATT	Use 1.25" COMFORTBOARD R5 and R22 COMFORTBATT	Use 2" COMFORTBOARD R8 and R14 COMFORTBATT	Use 1.25" COMFORTBOARD R5 and R22 COMFORTBATT	Use 1.25" COMFORTBOARD R5 and R22 COMFORTBATT	Use 1.25" COMFORTBOARD R5 and R22 COMFORTBATT

Basement Wall

MMAH Supplementary Standard SB-12 - Table 3.1.1.2.A (IP)

ZONE 1 Compliance Packages for Space Heating Equipment with AFUE > 92%							
	A1	A2	A2	A3	A4	A5	A6
Minimum Nominal R (ci=continuous insulation)	20ci	20ci	12+10ci	20ci	20ci	12+5ci	20ci
	See Notes	See Notes	Use 2.5" COMFORTBOARD	See Notes	See Notes	Use 1.25" COMFORTBOARD	See Notes

Notes to Table 3.1.1.2.A (IP):

Basement Walls: In the case of basement wall assemblies, where R20ci is required R12+10ci is permitted to be used or vice versa; or where R12+5ci is required, R15ci is permitted to be used or vice versa.

Options Include:

COMFORTBOARD 2.5" X 4' X 6' R10 and COMFORTBATT R14 | COMFORTBOARD 2" R8 OR 2.5" R10 and rigid foam 1.5" R7.5
See local building department for alternate solutions to continuous insulation interpretation.

ZONE 2 Compliance Packages for Space Heating Equipment with AFUE > 92%							
	A1	A2	A2	A3	A4	A5	A6
Minimum Nominal R (ci=continuous insulation)	20ci	20ci	20ci	20ci	20ci	20ci	20ci
	See Notes	See Notes	See Notes	See Notes	See Notes	See Notes	See Notes

Notes to Table 3.1.1.2.A (IP):

Basement Walls: In the case of basement wall assemblies, where R20ci is required R12+10ci is permitted to be used or vice versa; or where R12+5ci is required, R15ci is permitted to be used or vice versa.

Options Include:

COMFORTBOARD 2.5" R10 and COMFORTBATT R14 | COMFORTBOARD 2" R8 OR 2.5" R10 and 1.5" rigid foam R7.5
See local building department for alternate solutions to continuous insulation interpretation.

	R-Value	Dimensions	ROCKWOOL COMFORTBOARD	SQ.FT. PER PALLET
Available Sizes	R4	1" X 4' X 6'	110	960
	R5	1.25" X 4' X 8'	80	1024
	R6	1.5" X 4' X 6'	80	672
	R8	2" X 3' X 4'	80	576
	R10	2.5" X 4' X 6'	80	384

* Other board dimensions are available, contact your local ROCKWOOL representative for more information.

At the ROCKWOOL Group, we are committed to enriching the lives of everyone who comes into contact with our solutions. Our expertise is perfectly suited to tackle many of today's biggest sustainability and development challenges, from energy consumption and noise pollution to fire resilience, water scarcity and flooding. Our range of products reflects the diversity of the world's needs, while supporting our stakeholders in reducing their own carbon footprint.

Stone wool is a versatile material and forms the basis of all our businesses. With approx. 10,500 passionate colleagues in 38 countries, we are the world leader in stone wool solutions, from building insulation to acoustic ceilings, external cladding systems to horticultural solutions, engineered fibres for industrial use to insulation for the process industry and marine & offshore.

AFB®, CAVITYROCK®, COMFORTBATT®, CONROCK®, CURTAINROCK®, ROCKBOARD®, TOPROCK®, MONOBOARD®, ROXUL® are registered trademarks of the ROCKWOOL Group in USA and ROXUL Inc. in Canada.

ROCKWOOL™, COMFORTBOARD™, FABROCK™, ROXUL SAFE™, ROCKWOOL PLUS™, and AFB evo™ are trademarks of the ROCKWOOL Group in USA and ROXUL Inc. in Canada.

SAFE'n'SOUND® is a registered trademark used under license by Masonite Inc.



ROCKWOOL
8024 Esquesing Line
Milton, Ontario L9T 6W3
Tel: 1 800 265 6878
rockwool.com