

Linear and Trapezoidal Firestop Systems

Tools required

- Sharp insulation knife

Ancillary products

Acoustic Intumescent Sealant, Ablative Coating

Fixing and application

The following installation requirements must be met in order to reliably achieve the stated fire resistances.

1. Linear Firestop 2A must be fitted as rectangular pieces, tightly butt jointed and compressed by at least 5% in thickness (see Figures 1, 2 & 3).
2. Up to 3 layers may be used. Single layer firestopping will always be preferred, with multi-layer methods limited to those occasions where building tolerances demand practicality. All layers should be installed simultaneously. The height of void should not exceed the width of the Firestop.
3. Where the trapezoidal profile is offset from the compartment line, the Linear Firestop should be continued out to underdraw and support the Trapezoidal Firestop (see Figure 4).
4. The Linear Firestop can be mechanically fixed to the profile deck/concrete soffit using suitable fixings e.g. steel self-tapping screws or hammer fix anchors at 350mm maximum centres (minimum 3 fixings per 1m length of Firestop).
5. Where the Linear Firestop 2A is required to be fixed to the deck at distances in excess of 400mm, turn the 1m length of Firestop 90° and cut to required size to suit profile spacing. In such cases, secure each length of Firestop to the soffit using at least 2 fixings at both ends.

Figure 1

Profiled metal deck over blockwork wall

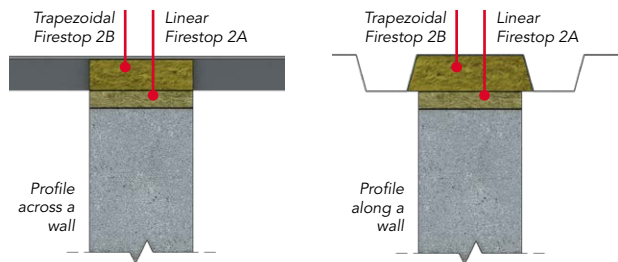

Figure 2

Profiled metal deck with/without concrete over a universal beam

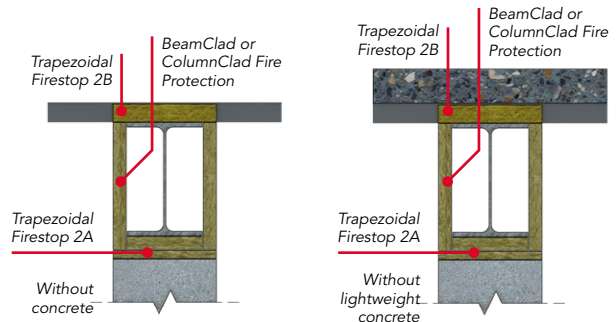
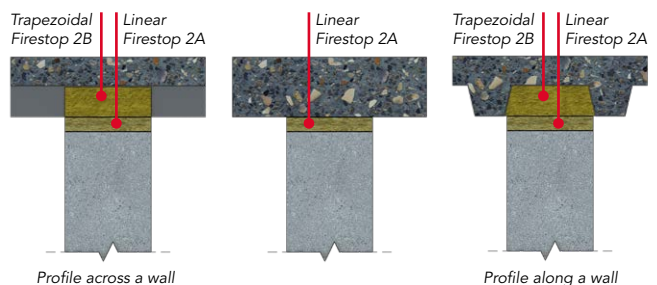

Figure 3

With/without profiled metal deck under a lightweight concrete slab



6. When fire stopping between the head of a fire resistant wall and the underside of a perforated roof deck insulated with ROCKWOOL HARDROCK® Multi-Fix [DD] flat roof insulation, it should be considered best practice to fill both the upper and lower deck profiles with Trapezoidal Firestop 2B products. In such cases, when placing an order it should be noted that the sizes of the two profiles may differ (see Figure 5).
7. Ensure a tight fit is achieved. Any minor gaps can be infilled using Acoustic Intumescent Sealant.
8. It is acceptable to paint visible areas of Linear or Trapezoidal Firestop using the Ablative Coating for an aesthetic finish.

Other installation information

Guidance on maintaining fire compartmentation is provided in Approved Document B (fire safety) Volume 2, Section 8 of The England and Wales Building Regulations 2019 edition. Effective compartmentation requires that the fire resistance should be continuous at the joint between elements forming a compartment.

ROCKWOOL Linear & Trapezoidal Firestops are designed to maintain the continuity of fire resistance of compartment walls and are reliant on the surrounding construction to maintain the same period of fire resistance.

Figure 4

The 'overhang' of the Linear Firestop 2A should be supported with steel self-tapping screws or 'hammer fix' anchors into deck / concrete soffit at 350mm maximum centres (minimum of 3 fixings per 1m length of Firestop).

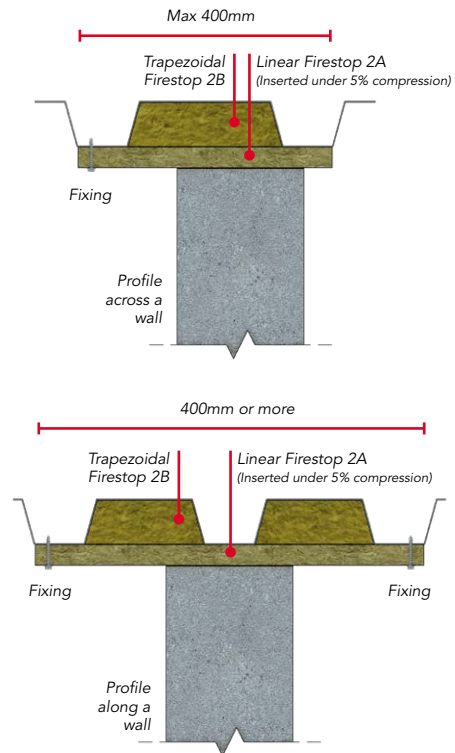
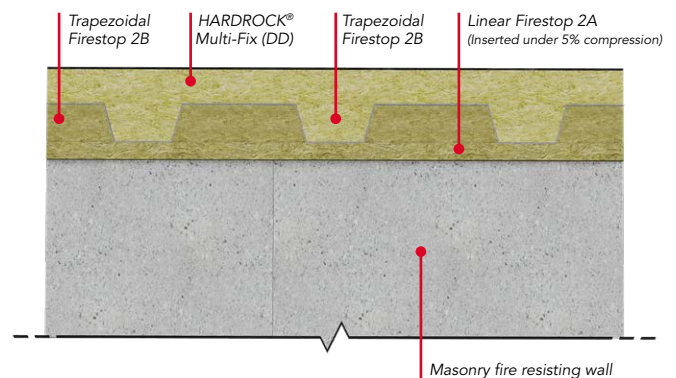

Figure 5

ROCKWOOL Insulated flat roof deck with profiles perpendicular to the wall line



Health & safety

The mechanical effect of fibres in contact with skin may cause temporary itching.



Cover exposed skin
When working in unventilated area wear disposable face mask.



Clean area using vacuum equipment.



Waste should be disposed of according to local regulations.



Rinse in cold water before washing.



Ventilate working area if possible.



Wear goggles when working overhead.