

Republic of Ireland Price List March 2024

Prices effective from 1st March 2024



Contact us



Customer Support Centre

To place an order or for a price enquiry please contact:

Email: customersupportcentre@rockwool.com
Telephone: 00 44 1656 868 400

Opening Times

Monday	6.30am-6.30pm
Tuesday	6.30am-6.30pm
Wednesday	6.30am-6.30pm
Thursday	6.30am-6.30pm
Friday	6.30am-5.30pm

Technical Solutions

For all technical product and application queries please contact:

Email: technical.solutions@rockwool.com
Telephone: 00 44 1656 868 490

Opening Times

Monday	9am-5pm
Tuesday	9am-5pm
Wednesday	9am-5pm
Thursday	9am-5pm
Friday	9am-4pm

Full load pallet quantities

To assist with load building, we have outlined below how many pallets comprise a full load for each of the available pallet sizes. Depending upon the pallet size and product, the number of pallets in a full load will vary, we have outlined below the details for these.

Pallet Size: 1200 x 1200mm

FULL LOAD = 22 PALLETS

- Angle Fillet
- Cladding Roll
- Ductslab
- Ductwrap
- Fire Barrier
- Flexi®
- Full Fill Cavity Batts
- High Performance Partial Fill Cavity Slab
- NyRock® Cavity Slab 032
- NyRock® Frame Slab 032
- RainScreen Duo Slab®
- Roll
- Rollbatt
- RWA45
- RW3
- Steel Frame Slab
- Timber Frame Slab
- Twin Roll

FULL LOAD = 42 PALLETS

- FirePro® Ablative Coated Batt

Pallet Size: 1300 x 1200mm

FULL LOAD = 40 PALLETS

- Party Wall Cavity Barrier
- TCB Cavity Barrier

Pallet Size: 2400 x 1200mm

FULL LOAD = 22 PALLETS

- HardRock® UB34
- High Impact Soffit Slab
- RW4 (Plain)
- RW5 (Plain)
- NyRock RainScreen 032

Pallet Size: 1200 x 1000mm

FULL LOAD = 52 PALLETS

- Acoustic Infill
- Fire Duct Section
- Fire Tube
- HardRock® Multi-Fix (DD)
- HardRock® Multi-Fix Recovery Board
- RockFloor®
- RockLap H&V Pipe Section

Pallet Size: 2000 x 1000mm

FULL LOAD = 26 PALLETS

- Fire Barrier Slab

Pallet Size: 2000 x 1200mm

FULL LOAD = 26 PALLETS

- Fire Duct Slab (Foil Faced)
- FirePro® DuctRock® Slab
- FirePro® SP FireStop EN
- BeamClad®
- RW4 (Foil/Tissue Faced)
- RW5 (Foil/Tissue Faced)
- RW6 (Foil/Tissue Faced)
- Soffit Slab

Pallet Size: 1300 x 1000mm

FULL LOAD = 20 PALLETS

- Acoustic Membrane

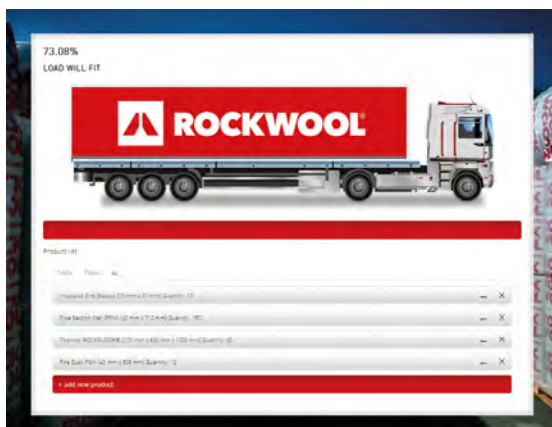

Indicative Load Calculator

The Load Calculator forms part of the ROCKWOOL full service offering to make product selection and transportation quicker and easier, providing support to build your loads, ensuring all requirements are able to fit on the vehicle.

Try it for yourself at:

www.rockwool.com/uk/loadcalc

Helping you meet demand



We are continuing to invest in logistics at ROCKWOOL to ensure that you receive the best possible service - that means getting you what you need, when you need it.

Some of our latest improvements include:

- The ROCKWOOL National Logistics Centre, a dedicated and expert hub for our inward and outbound logistics including a 60,000m² hard stand to help mobilise stock faster.
- An upgraded fleet, including branded artic and rigid vehicles for local and specialist deliveries. Whatever your needs, we've got a vehicle to suit.
- Not to mention continual improvements behind the scenes to ensure your products are picked, packaged and shipped in a timely and effective manner.

Contents

Terms and Conditions	Page No.	6
Delivery		7
The Euroclass System		10
Technical Tools and Resources		12

THINK YOU KNOW NYROCK?

NyRock® Cavity Slab 032	14
NyRock® Frame Slab 032	17
NyRock® Rainscreen 032	20

BUILDING INSULATION

CAVITY SOLUTIONS	14
NyRock® Cavity Slab 032	14
RockClose® Insulated DPC	15
Full Fill Cavity Batts	15
High Performance Partial Fill Cavity Slab	15
FRAME SOLUTIONS	16
NyRock® Frame Slab 032	17
Timber Frame Slab	17
Steel Frame Slab	17
CLADDING SOLUTIONS	18
RainScreen Duo Slab®	19
NyRock® Rainscreen 032	20
Cladding Roll	21
SP FireStop OSCB 25	22
SP FireStop OSCB 44	23
SP FireStop Slab®	23
FLAT ROOF SOLUTIONS	25
HardRock® UB34	26
HardRock® Multi-Fix (DD)	26
HardRock® Underlay Slab	27
HardRock® Multi-Fix Recovery Board	27
HardRock® Multi-Fix Angle Fillet	27
Acoustic Infill	28
Acoustic Membrane	28
FLOOR SOLUTIONS	30
Acoustic RockFloor®	31
Thermal RockFloor®	31
ROLL PRODUCTS	32
Twin Roll	33
Roll	33
Rollbatt	33
SLAB PRODUCTS	34
Flexi®	35
RW Slab Range RWA45	35
RW Slab Range RW3, RW4, RW5	36

TECHNICAL INSULATION

FIRE PROTECTION SOLUTIONS	38
BeamClad®	39
FirePro® Glue	39
FirePro® Fire Barrier System	40
FirePro® Fire Tube	41
Soffit Slab	42
High Impact Soffit Slab	42
FIRE STOPPING SOLUTIONS	44
FirePro® SP FireStop EN	45
SP FireStop Fixing Brackets	45
Thermal Cavity Barriers	46
Party Wall Cavity Barriers	46
FirePro® Ablative Coated Batt	47
FirePro® Ablative Liquid	47
FirePro® Acoustic Intumescent Sealant	47
FirePro® Silicone X	48
FirePro® FireStop Compound	48
FirePro® High Strength FireStop Compound	48
FirePro® High Expansion Intumescent Sealant	49
FirePro® Intumescent Pipewrap Roll	49
FirePro® SpeedSeal	49
FirePro® Insulated Fire Sleeve	50
FirePro® Insulated Fire Duct Sleeve	50
FirePro® Intumescent Pillow CE	51
FirePro® Intumescent Putty Pads	51
FirePro® Intumescent Pipe Wrap CE	52
FirePro® Linear Firestops	53
Dovetail Infill	53
FirePro® Trapezoidal Firestops	54
FirePro® Pipe Collar CE	55
FirePro® SoftSeal System	56
HVAC PRODUCTS	58
Ductslab and Ductwrap	59
DuoDuct External Ductslab	59
FirePro® DuctRock® Slab	60
RockLap H&V Pipe Sections	62-63
RockLap H&V Pipe Supports	64-65
Techtube	66
Techwrap2	66
Fire Duct Slab	67
Fire Duct Section	67

Terms and Conditions

At ROCKWOOL, we have been manufacturing and stocking products locally for over 40 years. Our aim at all times is to give you the best possible customer experience.

To help offer you the very best service, we hold stocks in our newly expanded Logistics Centre in Bridgend of the most popular products. Everything contained in this price list is a Stocked item unless it has been designated as Made to Order.

In Stock

Delivery times for In Stock items will be communicated within the order confirmation provided.

If your order is made up of a mixture of In Stock and Made to Order products, the order will be delivered in line with the longest lead time.

The minimum order quantity will consist of one pallet of a single product thickness, unless otherwise stated.

Made to Order

Identified by a • symbol.

We know that occasionally you need something that's a little out of the ordinary, so we've also listed a selection of Made to Order products - these are labelled within the product tables.

Delivery times for Made to Order items will be communicated within the order confirmation provided.

If your order is made up of a mixture of In Stock and Made to Order products, the order will be delivered in line with the longest lead time.

Orders for Made to Order products cannot be accepted for less than the minimum order quantity displayed. The full order quantity must be taken as part of a single order which may be taken over multiple deliveries over a one month period.

Once ordered, Made to Order products cannot be cancelled and the full costs will be applied.

Non-Standard Products

Bespoke product and products not listed within this price list are defined as "Non-Standard Products."

Due to the nature of Non-Standard Products, prices and minimum order quantities will only be confirmed on request (within 5 working days). Lead times will be communicated in the same way as Made to Order items.

Orders for Non-Standard Products cannot be accepted for less than the confirmed minimum order quantity. The full order must be taken as part of a single order which may be taken over multiple deliveries within a period of one month.

Fabrication Plant

Products manufactured in our fabrication plants are subject to different delivery service. Please see product listing for more information.

Lead times for fabricated products can vary and will be confirmed on receipt of order.

Re-stocking/Returns

In exceptional circumstances and at our discretion some Stocked products may be returned. You will be responsible for the cost of collection of any agreed returns, and a re-stocking fee of a minimum of 25% of the list price will apply. A credit note will only be supplied if the product returned is in a saleable condition.

Made to Order and Non-Standard products cannot be returned.



Whilst every effort has been made to ensure the accuracy of this price list and its contents, ROCKWOOL reserves the right to alter in the event of any errors or omissions. All prices listed are exclusive of VAT. E&OE.

For our full Terms and Conditions please visit www.rockwool.com/uk/tandcs



Delivery

Whether delivering to yard or direct to site, ROCKWOOL has a variety of delivery option designed to meet your needs.



Delivery Charges: All full load deliveries are made free of charge (UK mainland only). Deliveries of less than one full load will incur charges as outlined below.

Pallet Size:		2400 x 1200mm 1200 x 1200mm		2000 x 1200mm 2000 x 1000mm		1200 x 880mm		1300 x 1200mm		1200 x 1200mm		1200 x 1000mm	
Load	Cost	Pallet Load: 22		Pallet Load: 26		Pallet Load: 28		Pallet Load: 40		Pallet Load: 44		Pallet Load: 52	
		Min	Max	Min	Max	Min	Max	Min	Max	Min	Max	Min	Max
Full load	€0	22	22	26	26	28	28	40	40	44	44	52	52
60-99%	€195	13	21	16	25	17	27	24	39	26	43	31	51
50-59%	€235	11	12	13	15	14	16	20	23	22	25	26	30
25-49%	€325	6	10	7	12	7	13	10	19	11	21	13	25
0-24%	POA	1	5	1	6	1	6	1	9	1	10	1	12

Need help planning your delivery load? Why not use our online load calculator? www.rockwool.com/uk/loadcalc

Half Loads

Subject to availability and to the costs shown in the table above, half loads or more qualify for a timed delivery within a two hour window.

Loads which are less than half full are scheduled over a five working days period. You can secure a timed delivery within a two hour window for an additional charge of €330.

Collections

Collections in a suitable vehicle can be arranged from ROCKWOOL in Pencoed, Bridgend between 7am and 12 noon Monday to Friday.

The ROCKWOOL Customer Support Centre will provide information on this service as required.

Please Note: all other terms and conditions remain the same.

Delivery Vehicles

Our standard delivery vehicle is a 16.5m articulated HGV, weighing up to 44T, which may not be suitable for all sites. We aim to offer you the most sustainable, practical and cost effective delivery service possible, so we have also provided alternative delivery vehicle options for you to select from. If your delivery requires any of the options listed below please contact our Customer Support Team.

Standard Delivery	Alternative Delivery Options - charges listed are in addition to table above		
16.5m Articulated HGV (44 Tonnes)	Flat Bed + €250 <small>A crane will be required for offloading.</small>	Restricted Site Access <small>If your delivery destination has restricted site access, please contact our Customer Support Team.</small>	Rigid - POA



Delivery

Amending Orders

For stocked items, orders can be amended without charge up to 4 working days before dispatch or additional charges will apply.

For made-to-order products, if manufacturing has commenced orders cannot be cancelled or amended, and the full costs of the products will be applied.

Cancelled Deliveries

No customer order cancellations will be accepted after 3 working days following the date of issue of the order confirmation by ROCKWOOL.

Stocked Items

- For products which have not been loaded, no charges will apply
- For products which have been loaded but have not left the site, a minimum handling charge of €110 will apply
- For products which are in transit for delivery, handling and transport costs will apply and will be confirmed by ROCKWOOL Customer Support Centre at the time of cancellation.

Made to Order Items

- For products which have not been manufactured, no charges will apply
- For products which have been manufactured, the full order value will be charged
- For products which have been manufactured and are in transit for delivery, the full order value plus handling and transport costs will apply.

Postponed Deliveries

Stocked Items

The storage charge will be €110 per trailer per day.

Made to Order Items

Storage charges will apply for Made to Order product deliveries that are postponed after the product has been manufactured. The storage charge will be €110 per trailer per day.

Postponed Flat Bed Deliveries

Deliveries requested on flat bed trailers which are postponed within 48 hours of the agreed delivery date will be subject to postponement charges. Storage charges will apply.

Refused Deliveries

Deliveries which are refused for any reason (e.g. windage, weather conditions etc) will incur costs which will include the delivery and return charges and ROCKWOOL handling fees.

Redirected Deliveries

Deliveries that are redirected from the agreed delivery destination will incur charges. ROCKWOOL Customer Support Centre will confirm these costs at the time of request.

Split Deliveries

We offer limited split deliveries on request where possible.

- Up to 20 miles between deliveries, from €80
- Other distances POA.

Delayed Off-Loading

Waiting time charges at €80 per hour pro-rata will apply if the delivery vehicle is not off-loaded within two hours of the requested delivery time.



Please Note:

Where you see this symbol different delivery details apply. Please see associated text for information.

Clarín College, Athenry



Client:

Department of Education & Skills,
Government of Ireland

Architect:

Healy Partners Architects

Main contractor:

JJ Rhatigans

Roofing contractor:

Priority Roofing

Product:

ROCKWOOL HARDROCK®
Multi-Fix Dual Density (DD)



Technical Support

The Euroclass System

The Euroclass Reaction to Fire system classifies building products in accordance with BS EN 13501-1. Using a product's Euroclass rating as guidance is the only way to determine a product's full Reaction to Fire performance. Products classified A1 or A2-s1, d0 are considered non-combustible and those classified B - F are considered combustible.

Products are classified from A1-F:

Euroclass	Combustibility
A1 A2-s1, d0	Non-combustible
B	
C	
D	Combustible:
E	Will burn and may char or flame
F	
NPD	

Important Points to Remember...

- To be sure of a product's Euroclass rating, simply check its Declaration of Performance (DoP).
- A1 and A2 classified products are tested in accordance with the non-combustibility test EN ISO 1182* to identify that they will not, or significantly not contribute to fire.
- All ROCKWOOL DoPs are available online at rockwool.com/dop

**A2 products can be tested to either EN ISO 1182 or EN ISO 1716.*

Learn anytime, anywhere

Introducing ROCKWOOL Learning

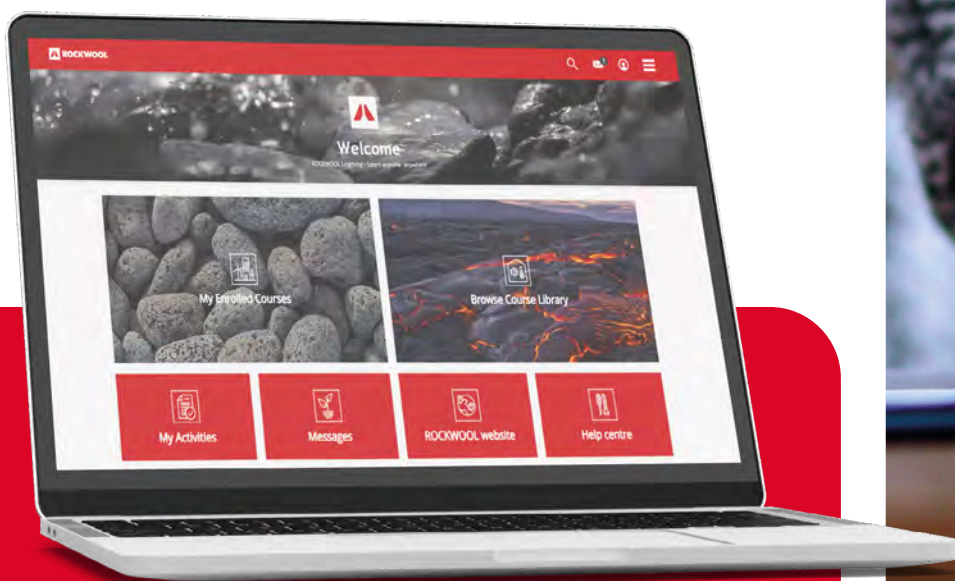

ROCKWOOL Learning makes it easier for construction professionals to access professional development opportunities and track progress with accredited CPD hours.

Register today to:

- Build a self-guided learning pathway
- Track your completed courses and CPD hours
- Expand your knowledge at a time and place that suits you
- Develop your knowledge of construction and insulation best practice



[< Back to Contents Page](#)



[rockwool.com/
uk/learning](https://rockwool.com/uk/learning)

rockwool.com/uk

T: 00 44 1656 868 400

11

Technical Tools and Resources

To assist you in the best possible way, we offer a range of free tools ranging from online software for calculating energy and heat loss to a materials calculator and much more.

Whether you are still at the beginning of your project or need technical support throughout, we are here to help along the way.



Fire Stopping Standard Details Guide

The ROCKWOOL Fire Stopping Standard Details Guide provides in-depth guidance on the performance parameters of our passive fire stopping product solutions according to tested installations and applications.

BIM Solution Finder

ROCKWOOL is proud to provide the BIM Solution Finder that will allow you to have the confidence in downloading the most recent BIM objects and the most up to date data for your projects.



Flat Roof Zoning Tool

The ROCKWOOL Zoning Tool has been developed to ensure the efficient use of insulation products across a flat roof. Simply draw the roof borders, then zone the roof into different areas depending on the application.

Acoustic Calculator

The ROCKWOOL Acoustic Calculator has been developed to provide reliable acoustic predictions for multiple building applications.

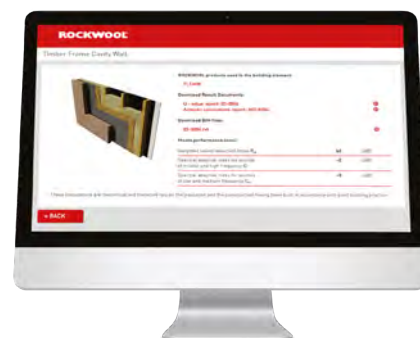

U-Value Calculator

Our U-value calculation tool allows you to quickly and easily calculate the thermal performance of walls, floors and roofs, with around 2,500 predetermined calculations all completed under the BBA/TIMSA U-value competency scheme. It also helps you to specify the correct product and thickness to meet your customers' requirements.

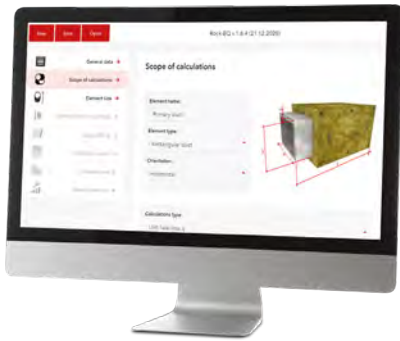

Rock-EQ Calculator

Specifying the insulation for your HVAC systems is now easier thanks to the ROCKWOOL HVAC Calculation Tool.

ROCKWOOL Resource Hubs...

Digital specification support for insulation applications.

Use the Resource Hubs to identify the right non-combustible stone wool insulation products for specific applications.

Explore the ROCKWOOL Resource Hubs now.

www.rockwool.com/uk/resource-hubs



Mapped to key insulation application areas, the ROCKWOOL Resource Hubs provide access to technical tools, data, guidance and installation support all in one place:



FirePro®
When specifying FirePro® products, the suite of resources provides guidance on all things passive fire protection.



Ventilated Façade
Bringing together all relevant technical literature, the resource hub helps specifiers to navigate routes to compliance when using ventilated façades.



Acoustic
Helping to better understand the role of building acoustics, specialist acoustics resources for creating safe and sound environments can be found here.



Building Services and HVAC
A comprehensive suite of resources designed to save time and make it easier to deliver robust project specifications.



Flat Roof
Support the design of flat roof insulation with specialist tools, guidance and technical data.

Cavity Solutions

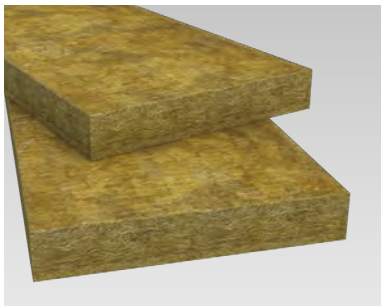

NyRock® Cavity Slab 032

NyRock® Cavity Slab 032 is a full and partial fill stone wool slab designed for the thermal insulation of masonry cavity walls.

Suitable for use in new builds, renovations or extensions, the lightweight slabs are easy to handle and simple to install providing an accurate fit against the blockwork.

Lambda 0.032 W/mK

Pallet Size 1200 x 1200mm

Product Code	Thickness (mm)	Width (mm)	Length (mm)	Pieces/ Pack	Area/ Pack (m ²)	Packs/ Pallet	Area/pallet (m ²)	Made to Order	MOQ (Pallet)	List Price/m ²
326646	100	455	1200	4	2.18	15	32.70			€33.13
326652	125	455	1200	3	1.64	15	24.60			€41.40
326657	150	455	1200	2	1.09	20	21.80			€49.68
330079	160	455	1200	2	1.09	20	21.80			€55.64
326660	200	455	1200	2	1.09	15	16.35			€66.23

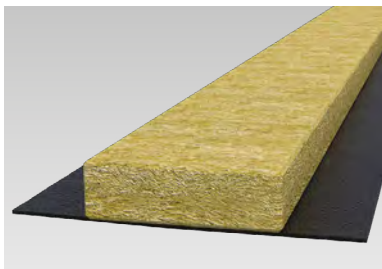

RockClose® Insulated DPC

RockClose® Insulated DPC is an insulated non-combustible cavity closer. The product is designed to minimise thermal bridging around windows and doors in first-fix cavity wall installations with a returning inside leaf. Designed to be installed as work proceeds between the outer masonry leaf and internal closer block prior to the frames being fitted.

DPC length: 1300mm. DPC width: 180mm. Pallet Size 1200mm x 1200mm

Product Code	Thickness (mm)	Width (mm)	Length (mm)	Linear m/ Pallet	Made to Order	MOQ (Linear m)	List Price/ Linear m
265258	20	100	1200	1056	•	200	€44.39
265265	30	100	1200	720	•	200	€50.05
265266	50	100	1200	432	•	200	€51.80



RockClose® orders cannot be used to contribute towards mixed loads. The lead times for these products can vary and will be confirmed on receipt of order. Additional carriage charges may be applied.

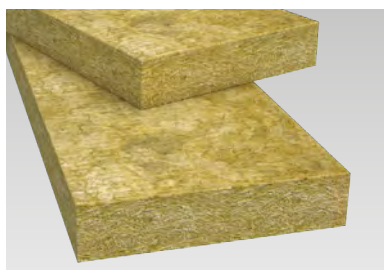

Full Fill Cavity Batt

Full Fill Cavity Batt is non-combustible and contains water repellent additives which prevent moisture transmission between the outer and inner leaf.

Lambda 0.037 W/mK

Pallet Size 1200 x 1200mm

Product Code	Thickness (mm)	Width (mm)	Length (mm)	Pieces/ Pack	Area/ Pack (m ²)	Packs/ Pallet	Area/ Pallet (m ²)	Made to Order	MOQ (Pallet)	List Price/m ²
122878	50	455	1200	12	6.55	15	98.28			€10.07
122880	75	455	1200	9	4.91	15	73.71			€15.10
122881	80	455	1200	8	4.37	15	65.52			€16.09
122883	100	455	1200	6	3.28	25	81.90			€20.12
122888	150	455	1200	4	2.18	25	54.60	•	22	€30.14



High Performance Partial Fill Cavity Slab

High Performance Partial Fill Cavity Slab is a semi-rigid partial fill insulation solution for masonry and framed cavity wall construction. It is designed to withstand typical conditions on-site and absorb any irregularities on the inner leaf. Consisting of a robust outer surface engineered to a resilient inner face. The slabs knit together when tightly butt jointed, eliminating heat loss caused by gaps.

Lambda 0.035 W/mK, Lambda 0.034 W/mK*

Pallet Size 1200 x 1200mm

Product Code	Thickness (mm)	Width (mm)	Length (mm)	Pieces/ Pack	Area/ Pack (m ²)	Packs/ Pallet	Area/ Pallet (m ²)	Made to Order	MOQ (Pallet)	List Price/m ²
123361*	50	455	1200	8	4.37	15	65.52	•	44	€65.24
123364*	80	455	1200	8	4.37	10	43.68	•	44	€99.12
181210	100	455	1200	6	3.28	10	32.76	•	44	€123.93
123371	120	455	1200	5	2.73	10	27.30	•	44	€156.50
253975	150	455	1200	4	2.18	10	21.84	•	44	€195.80
256027	170	455	1200	4	2.18	10	21.84	•	44	€221.97

Frame Solutions

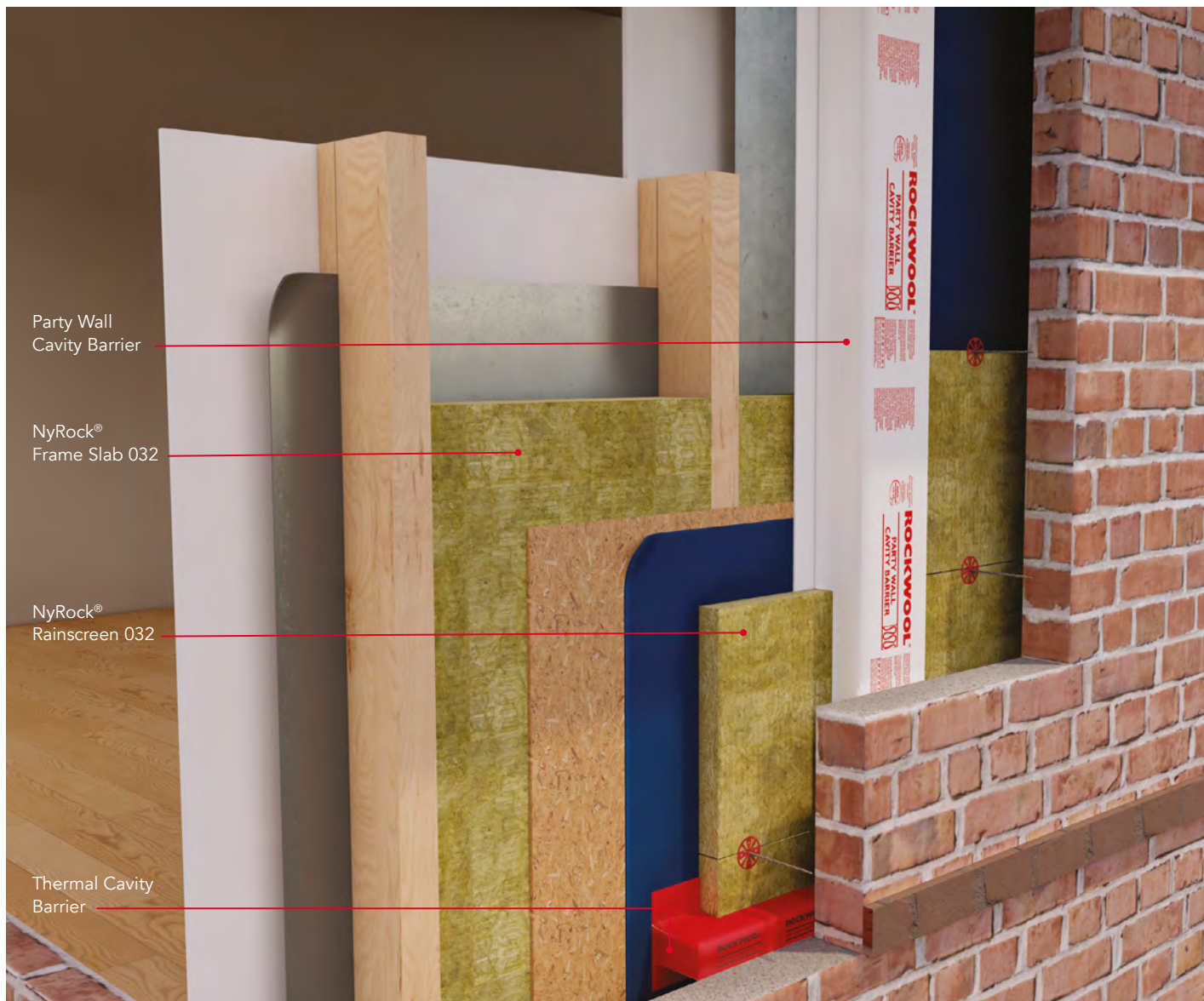

ROCKWOOL Frame Slabs are manufactured using a unique highspeed spinning process to produce stone wool insulation that is both light weight, for ease of installation, as well as low lambda, to help meet more demanding thermal performance requirements.

The slabs also provide acoustic protection and are Euroclass A1 non-combustible. Available in a variety of widths and thicknesses to suit the typical stud apertures of timber and steel frame constructions.

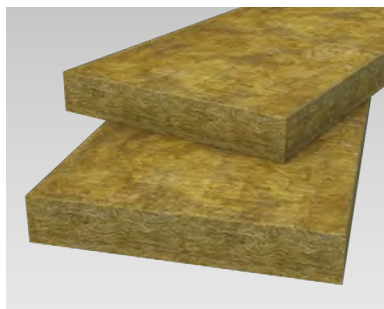

NyRock® Frame Slab 032

NyRock® Frame Slab 032 is a semi-rigid stone wool insulation slab designed specifically for use between the studwork of external timber or light gauge steel frame walls.

Manufacturing using NyRock® technology, the slabs deliver insulation with optimised density and performance; offering a low thermal conductivity designed to meet and exceed thermal building regulations.

Lambda 0.032 W/mK

Pallet Size 1200 x 1200mm

Product Code	Thickness (mm)	Width (mm)	Length (mm)	Pieces/ Pack	Area/ Pack (m ²)	Packs/ Pallet	Area/ Pallet (m ²)	Made to Order	MOQ (Pallet)	List Price/m ²
326566	90	570	1200	4	2.74	12	32.83	•	22	€24.77
326599	140	570	1200	3	2.05	12	34.56			€37.64
323861	100	600	1200	3	2.16	16	28.80			€25.59
326570	120	600	1200	2	1.44	20	24.62	•	22	€30.64
326600	150	600	1200	2	1.44	16	23.04			€38.37

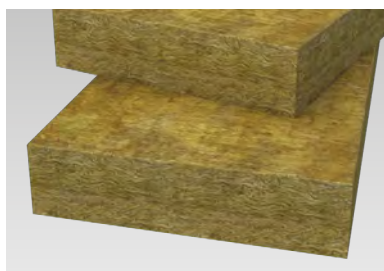

Timber Frame Slab

With an increased focus on compliance with thermal, fire and acoustic performance for external walls, ROCKWOOL Timber Frame Slab has been engineered with an optimal density offering a low thermal conductivity, exceptional resistance to fire and outstanding sound absorption. The non-combustible stone wool insulation has dimensions specifically designed to enable quick and easy installation into timber frames.

Lambda 0.034 W/mK

Pallet Size 1200 x 1200mm

Product Code	Thickness (mm)	Width (mm)	Length (mm)	Pieces/ Pack	Area/ Pack (m ²)	Packs/ Pallet	Area/ Pallet (m ²)	Made to Order	MOQ (Pallet)	List Price/m ²
278730	90	570	1200	6	4.1	12	49.25	•	22	€19.03
278728	140	570	1200	4	2.74	12	32.83			€28.95
282203	140	400	1200	4	1.92	18	34.56	•	22	€28.95

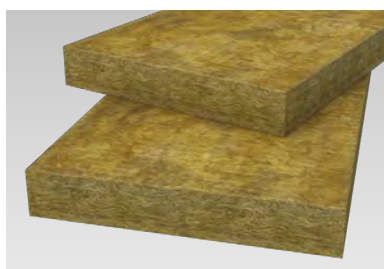

Steel Frame Slab

Designed for fast, high quality external wall installations, ROCKWOOL Steel Frame Slab can help to meet or exceed the requirements (thermal) of Part L of the Building Regulations, by delivering a low thermal conductivity of 0.034 W/mK. The slabs are lightweight, easy to handle and are supplied in 600mm widths. This ensures a tight friction fit into standard frames, with no gaps, saving on installation time and keeping waste to an absolute minimum.

Lambda 0.034 W/mK

Pallet Size 1200 x 1200mm

Product Code	Thickness (mm)	Width (mm)	Length (mm)	Pieces/ Pack	Area/ Pack (m ²)	Packs/ Pallet	Area/ Pallet (m ²)	List Price/m ²
278727	100	600	1200	6	4.32	12	51.84	€19.69
278712	120	600	1200	5	3.60	12	43.20	€23.59
278725	150	600	1200	4	2.88	12	34.56	€29.48

Cladding Solutions

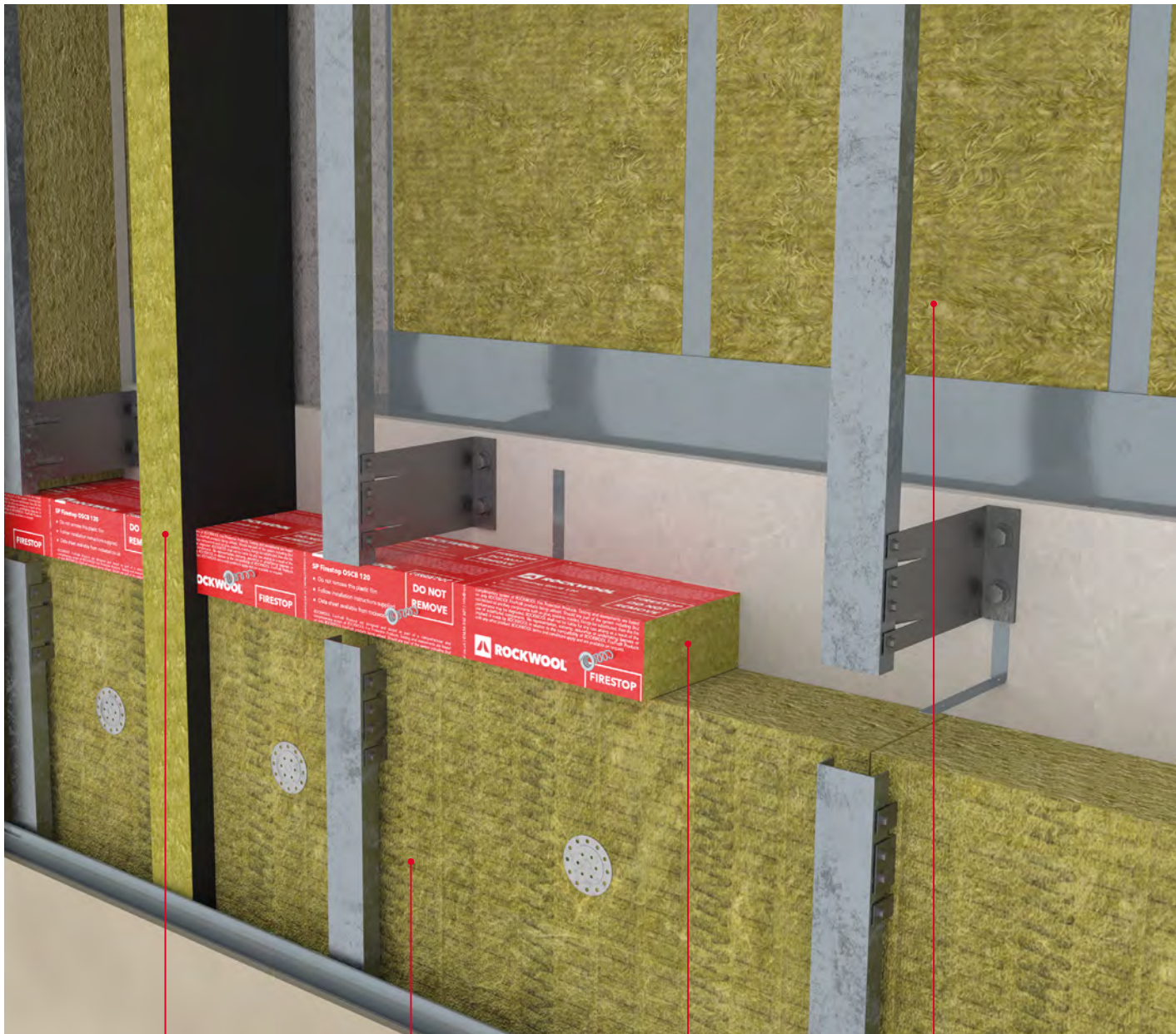

FirePro® SP
FireStop EN

Rainscreen Duo Slab or
NyRock Rainscreen 032

SP FireStop
OSCB

Steel Frame Slab
or NyRock
Frame 032

ROCKWOOL cladding solutions offer lightweight thermal, fire and acoustic cladding insulation suitable for external wall and roof applications.

These include ventilated façade systems and built-up metal wall and roof systems. The ROCKWOOL range of cladding insulation delivers excellent fire protection and soundproofing performance, and are available in a variety of thicknesses.

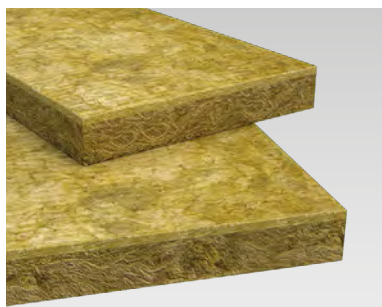

RainScreen Duo Slab®

RainScreen Duo Slab® is a dual density insulation board comprising a robust outer surface and a resilient inner face which has been designed for use in conditions of severe climatic exposure. Because of its unique dual density construction RainScreen Duo Slab® requires fewer fixings, thus providing a cost effective solution in over cladding applications.

Lambda 0.035 W/mK, Lambda 0.034 W/mK*

Pallet Size 1200 x 1200mm

	Product Code	Thickness (mm)	Width (mm)	Length (mm)	Pieces/ Pack	Area/ Pack (m ²)	Packs/ Pallet	Area/ Pallet (m ²)	Made to Order	MOQ (Pallet)	List Price/m ²
	221343*	50	600	1200	8	5.76	12	69.12			€36.37
	221347*	60	600	1200	6	4.32	12	51.84			€43.40
	221352*	75	600	1200	6	4.32	12	51.84			€54.42
	283606*	80	600	1200	4	2.88	16	46.08			€63.30
	221359	90	600	1200	4	2.88	12	34.56			€69.36
	348126	100	600	1200	4	2.88	16	46.08			€72.20
	348311	110	600	1200	4	2.88	16	46.08			€77.09
	300182	120	600	1200	4	2.88	12	34.56			€82.26
	300183	125	600	1200	4	2.88	12	34.56			€85.73
	348321	130	600	1200	4	2.88	12	34.56	•	22	€94.94
	348408	140	600	1200	3	2.16	16	34.56			€97.60
	348410	150	600	1200	3	2.16	16	34.56			€108.16
	348411	160	600	1200	3	2.16	12	25.92	•	22	€115.39
	348415	170	600	1200	3	2.16	12	25.92	•	22	€118.44
	348416	180	600	1200	3	2.16	12	25.92			€129.80
	348417	190	600	1200	2	1.44	16	23.04	•	22	€138.47
	348418	200	600	1200	2	1.44	16	23.04			€143.51
	348421	220	600	1200	2	1.44	16	23.04	•	22	€150.54
	348422	225	600	1200	2	1.44	16	23.04	•	22	€153.06
◆	254360	180	600	1000	3	1.80	10	18	•	22	€155.97

KEY: ◆ ALU Faced

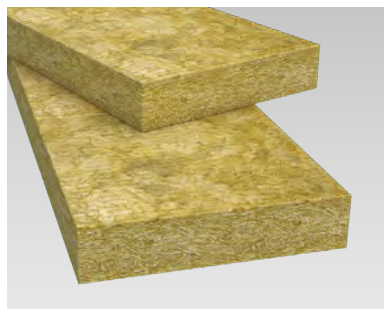

NyRock® Rainscreen 032

NyRock® Rainscreen 032 is specifically developed for use within ventilated cladding systems, as well as sealed systems such as curtain walling.

The product can be easily fitted around brackets and other awkward details, and when tightly butted, adjacent slabs effectively 'knit' together to provide a continuous insulating layer, reducing heat losses that would otherwise be caused by gaps.

Lambda 0.032 W/mK

Pallet Size 2400 x 1200mm

Product Code	Thickness (mm)	Width (mm)	Length (mm)	Pieces/ Pack	Area/ Pack (m ²)	Packs/ Pallet	Area/ Pallet (m ²)	Made to Order	MOQ (Pallet)	List Price/m ²
326324	50	600	1200	6	4.32	16	69.12	•	22	€43.84
328258	60	600	1200	6	4.32	12	51.84	•	22	€52.31
326354	70	600	1200	4	2.88	16	46.08	•	22	€61.03
326361	75	600	1200	4	2.88	16	46.08	•	22	€65.57
326362	80	600	1200	4	2.88	16	46.08			€76.28
328260	85	600	1200	3	2.16	20	43.20	•	22	€81.05
326364	90	600	1200	4	2.88	12	34.56			€83.60
326367	100	600	1200	3	2.16	16	34.56			€87.00
328261	110	600	1200	3	2.16	12	25.92			€92.92
326372	115	600	1200	3	2.16	12	25.92	•	22	€97.13
326376	125	600	1200	3	2.16	12	25.92			€103.31
326381	135	600	1200	3	2.16	12	25.92			€111.58
326383	150	600	1200	2	1.44	16	23.04			€130.35
326385	165	600	1200	2	1.44	12	17.28	•	22	€143.40
326395	180	600	1200	2	1.44	12	17.28	•	22	€156.42
326396	200	600	1200	2	1.44	12	17.28	•	22	€172.96



Cladding Roll

Cladding Roll is a lightweight, flexible mat which delivers a combination of thermal, fire and acoustic performance. Suitable for use within built up metal roof and wall applications ROCKWOOL® Cladding Roll is available in a variety of thicknesses and can be produced with an aluminium facing for increased tensile strength in vertical wall applications.

Lambda 0.040 W/mK

Pallet Size 1200 x 1200mm

Product Code	Thickness (mm)	Width (mm)	Length (mm)	Pieces/ Pack	Area/ Pack (m ²)	Packs/ Pallet	Area/ Pallet (m ²)	Made to Order	MOQ (Pallet)	List Price/m ²
122905	60	1200	3200	2	7.68	18	138.24			€9.14
122906	80	1200	5000	1	6.00	18	108.00	•	22	€12.17
122907	100	1200	4800	1	5.76	18	103.68			€15.20
122908	120	1200	4000	1	4.80	18	86.40	•	22	€18.30
122909	150	1200	3200	1	3.84	18	69.12			€23.56
255780*	150	1000	3200	1	3.20	21	67.20	•	22	€35.11
122911	180	1200	2700	1	3.24	18	58.32			€27.27
122913	220	1200	2200	1	2.64	18	47.52	•	22	€33.35

*Foil Faced For vertical applications we would strongly advise the use of foil faced cladding roll.

High rise residential, made easier

Design and specify effective high rise structures with our sector guide, 'ROCKWOOL for High Rise Residential Projects'.

Built around the concept that modern high rise homes should be as safe as they are comfortable, the guide offers:



Application-specific advice for insulation



Relevant case studies



Acoustic, thermal and fire protection performance guidance



Building regulations advice for high rise residential projects



More information on key ROCKWOOL resources and CPDs

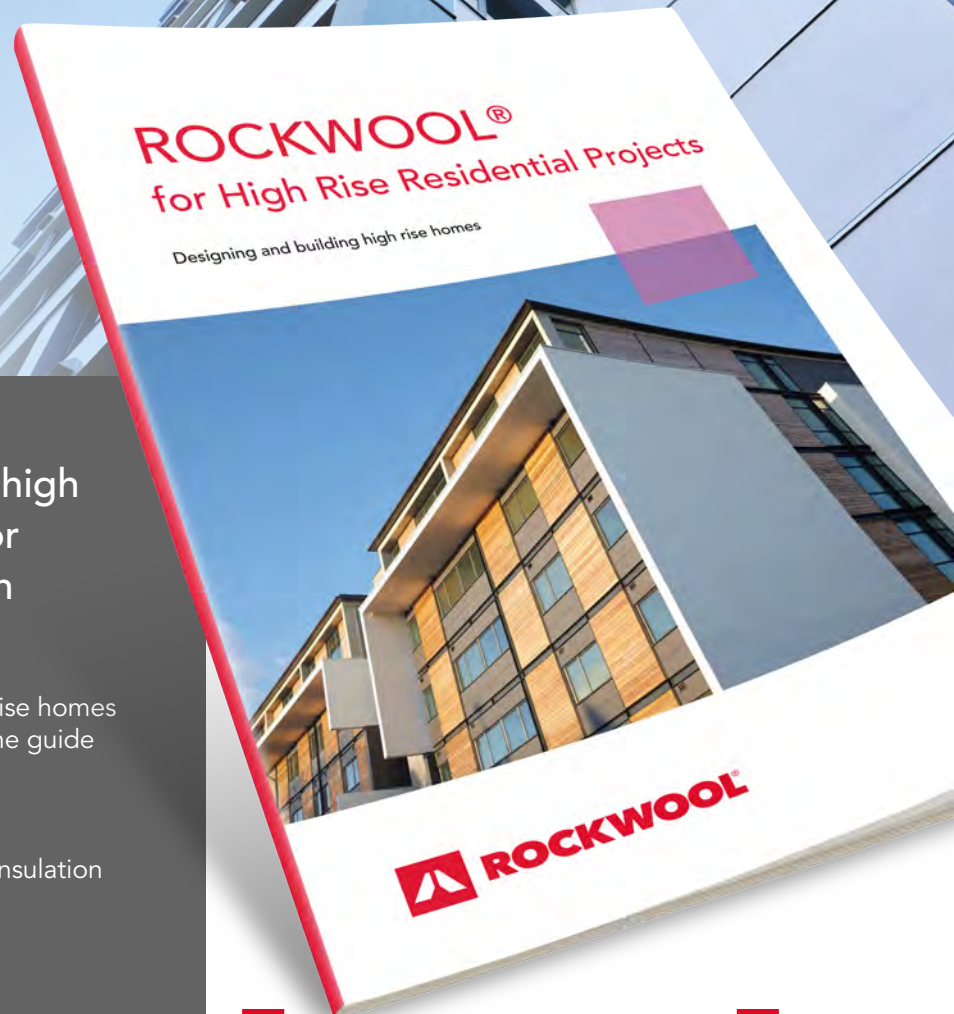

Download 'ROCKWOOL for High Rise Residential Projects':



rockwool.com/uk/high-rise



[X](#) [in](#) [f](#) [@](#) [▶](#)
rockwool.com/uk



SP FireStop OSCB 25

Specifically designed for use only in conjunction with either ROCKWOOL Rainscreen Duo Slab® or NyRock Rainscreen 032, SP FireStop OSCB 25* forms an open-state cavity fire barrier within the building façade, allowing for an open cavity of up to 25mm for ventilation and drainage.

This product provides up to 120 minutes integrity and insulation.

** Product codes for SP FireStop OSCB 25 will be supplied on receipt of order.*

Prices indicated are inclusive of stainless steel pigtail screws and galvanised steel fixing brackets. These items are supplied in a box located at the bottom of a clearly marked pallet. Stainless steel brackets are available at an extra cost of €3.24 per linear metre - please specify when ordering if these are required.

Please contact the ROCKWOOL Customer Support Team for further information.

Length 1000mm. Depth 90mm

Width Dimensions (mm)		List Price
Product	Max. Overall Cavity	
75	100	€38.79
80	105	€39.31
85	110	€39.81
90	115	€40.10
95	120	€40.43
100	125	€41.12
105	130	€41.51
110	135	€42.01
115	140	€42.14
120	145	€42.97
125	150	€43.18
130	155	€43.70
135	160	€44.27
140	165	€44.47
145	170	€44.70
150	175	€45.85
155	180	€46.00
160	185	€46.28
165	190	€46.43
170	195	€47.91
175	200	€48.05
180	205	€48.34
185	210	€48.56
190	215	€48.71
195	220	€48.92
200	225	€50.81
205	230	€51.10
210	235	€51.33
215	240	€51.46
220	245	€51.67
225	250	€51.80
230	255	€52.03
235	260	€52.19
240	265	€55.20
245	270	€55.34
250	275	€55.54
255	280	€55.70
260	285	€55.93
265	290	€56.06
270	295	€56.27
275	300	€56.49
280	305	€56.63

Width Dimensions (mm)		List Price
Product	Max. Overall Cavity	
285	310	€56.84
290	315	€57.27
295	320	€57.43
300	325	€61.97
305	330	€62.13
310	335	€62.34
315	340	€62.48
320	345	€62.70
325	350	€62.91
330	355	€63.04
335	360	€63.27
340	365	€63.42
345	370	€63.63
350	375	€63.78
355	380	€63.99
360	385	€64.57
365	390	€64.77
370	395	€65.00
375	400	€65.14
380	405	€65.36
385	410	€65.50
390	415	€65.72
395	420	€65.85
400	425*	€74.70
405	430	€74.93
415	440	€75.29
425	450	€75.67
435	460	€76.00
445	470	€76.43
455	480	€76.81
465	490	€77.17
475	500	€77.51
485	510	€78.76
495	520	€79.09
505	530	€79.45
515	540	€79.84
525	550	€80.17
535	560	€80.61
545	570	€80.97
555	580	€81.35
565	590	€81.69
575	600	€82.06



OSCB orders cannot be used to contribute towards mixed loads. These products are delivered direct from our fabrication plant. Additional carriage charges may apply. The lead times for these products can vary and will be confirmed on receipt of order.

* For voids equal to 425mm and up to 600mm a minimum thickness of 300mm of Rainscreen Duo Slab/NyRock Rainscreen 032 is required both above and below the cavity barrier.



SP FireStop OSCB 44

Specifically designed for use only in conjunction with either ROCKWOOL Rainscreen Duo Slab® or NyRock Rainscreen 032, SP FireStop OSCB 44* forms an open-state cavity fire barrier within the building façade, allowing for an open cavity of up to 44mm for ventilation and drainage.

This product provides up to 120 minutes integrity and insulation.

** Product codes for the OSCB 44 will be supplied on receipt of the order.*

Prices indicated are inclusive of galvanised steel fixing brackets. OSCB 44 does not require pigtail screws. The brackets are supplied in a box located at the bottom of a clearly marked pallet. Stainless steel brackets are available at an extra cost of €3.24 per linear metre - please specify when ordering if these are required. Please contact the ROCKWOOL Customer Support Team for further information.

Length 1000mm. Depth 90mm

Width Dimensions (mm)		List Price
Product	Max. Overall Cavity	
56	100	€63.02
61	105	€63.42
66	110	€63.80
71	115	€64.23
76	120	€64.61
81	125	€65.00
86	130	€65.42
91	135	€65.63
96	140	€66.04
101	145	€66.57
106	150	€66.75
111	155	€67.31
116	160	€67.51
121	165	€68.14
126	170	€68.34
131	175	€68.51
136	180	€69.27
141	185	€69.45
146	190	€69.65
151	195	€70.61
156	200	€70.73
161	205	€70.99
166	210	€71.17
171	215	€71.31
176	220	€72.52
181	225	€72.77
186	230	€72.96
191	235	€73.10
196	240	€73.30
201	245	€74.86
206	250	€75.13
211	255	€75.32
216	260	€75.46

Width Dimensions (mm)		List Price
Product	Max. Overall Cavity	
221	265	€75.66
226	270	€75.82
231	275	€75.96
236	280	€76.17
241	285	€78.64
246	290	€78.78
251	295	€78.96
256	300	€79.14
261	305	€79.28
266	310	€79.45
271	315	€79.60
276	320	€79.77
281	325	€79.92
286	330	€80.37
291	335	€80.50
296	340	€80.70
301	345	€84.44
306	350	€84.61
311	355	€84.75
316	360	€84.92
321	365	€85.07
326	370	€85.25
331	375	€85.40
336	380	€85.58
341	385	€85.77
346	390	€85.88
351	395	€86.10
356	400	€86.21
361	405	€86.82
366	410	€86.92
371	415	€87.12
376	420	€87.26
381	425	€87.45

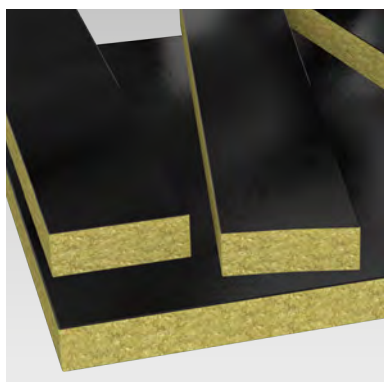

SP FireStop EN

FirePro® SP FireStop EN has been tested in accordance with BS EN 1366-4:2021 and is suitable for use as a linear cavity firestop in both vertical and horizontal orientations. SP FireStop EN has been tested with multiple substrate types including masonry/concrete, SFS and composite panels with a stone wool core.

SP FireStop EN has also been tested in accordance with BS EN 1364-4:2014, curtain walling - part configuration.

For pricing and further information please refer to page 45.

Introducing...

FirePro[®] SP FireStop EN

A cavity fire stopping solution suitable for vertical and horizontal installation.



Tested for use with steel frame substrate, composite panel and masonry applications



120 minutes integrity and insulation in cavities up to 600mm*



Tested to BS EN 1366-4:2021



Tested to curtain wall standard
BS EN 1364-4:2014



Suitable for 'installation from below'

*Subject to the application

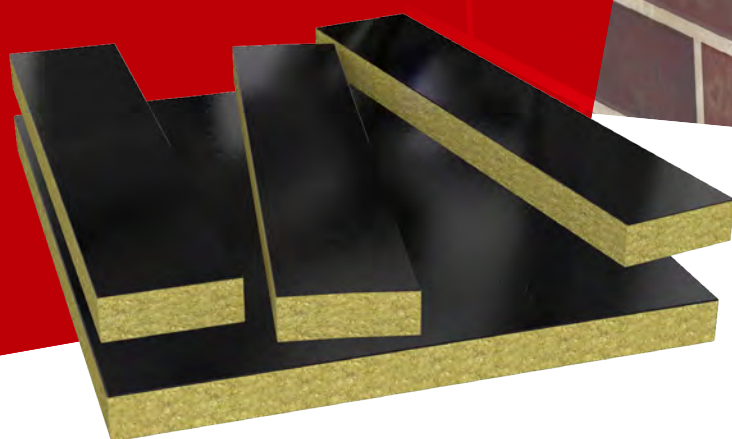

Find out more:



[rockwool.com/uk/
sp-firestop-en](https://rockwool.com/uk/sp-firestop-en)



[X](#) [in](#) [f](#) [@](#) [▶](#)
rockwool.com/uk

Flat Roof Solutions

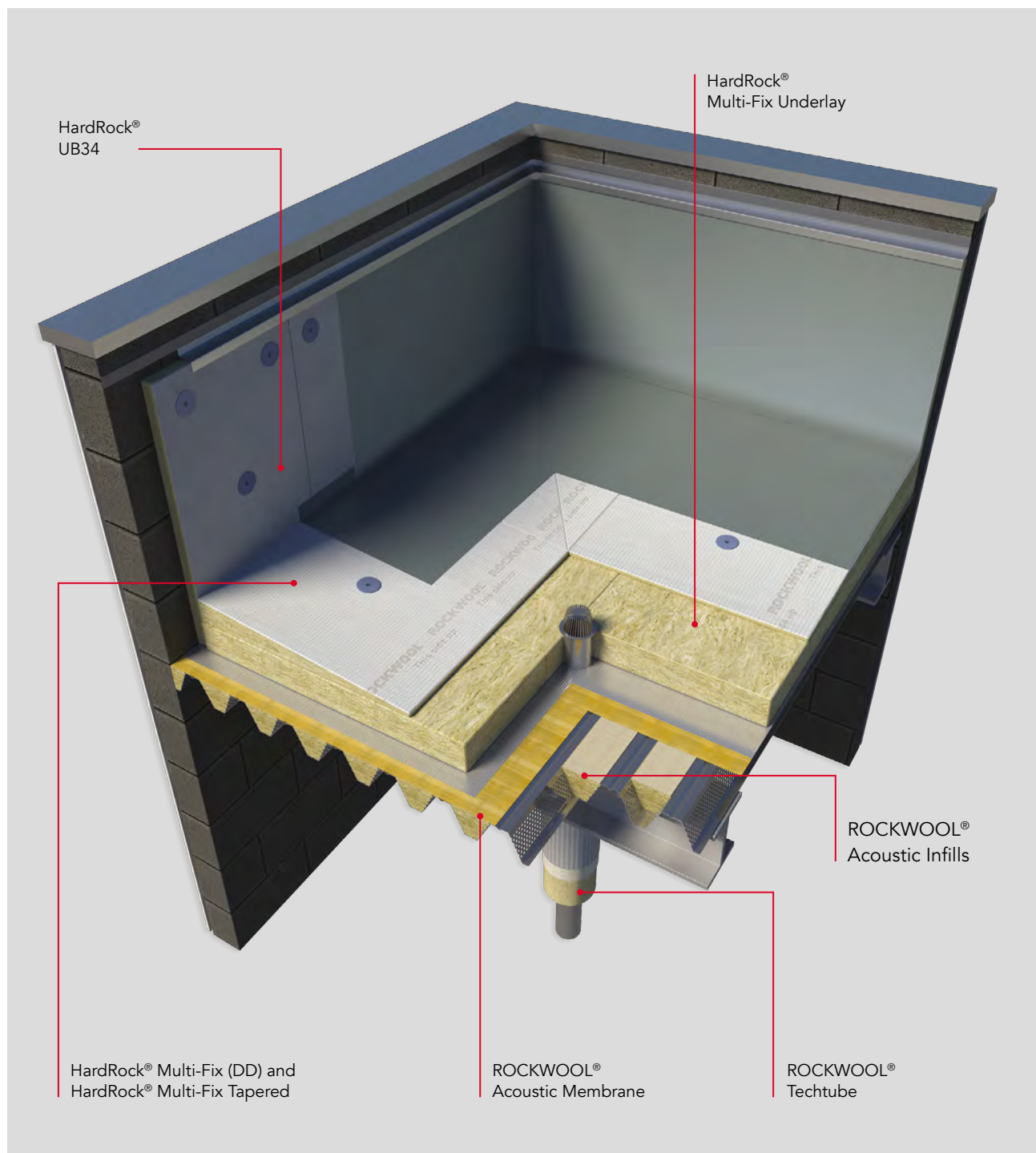

ROCKWOOL flat roof solutions have been designed to meet the demands of modern roof systems, providing durable solutions which simplify design.

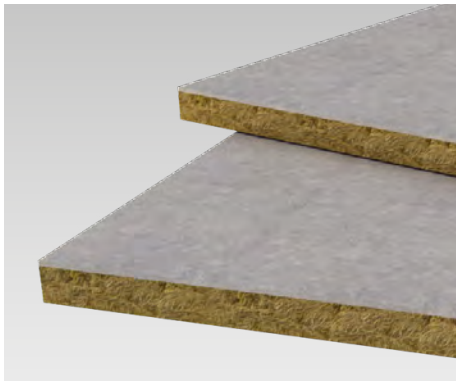

HardRock® UB34

Consisting of non-combustible ROCKWOOL insulation faced with an exterior grade non-combustible 6mm fibre cement board, HardRock UB34 achieves a EUROCLASS fire classification of A2, s1-d0, offering a non-combustible solution for insulating upstands and parapet walls.

Lambda 0.034 W/mK

Pallet Size 2400 x 1200mm

Product Code	Additional Information	Thickness (mm)	Width (mm)	Length (mm)	Pieces/Pallet	Area/Pallet (m ²)	Made to Order	MOQ (Pallet)	List Price/Board
284556	6mm exterior grade fibre cement board	56	600	1200	72	51.84	•	1	€118.48

When it comes to specifying high performing non-combustible insulation, the majority of focus has been on external walls - but overlooking the roof could introduce a weak link into the building envelope. According to government reports, between 2010 and 2018 there were 4,290 fires in England where the roof was deemed to have been “mainly responsible for the development of the fire”.^{*} We urge you to push the envelope and specify ROCKWOOL on your build as it is just as important to have non-combustible, thermally efficient insulation on the roof as it is on the façade.

Lisa Stephens, Product Manager – Flat Roof & Façades

^{*}Source: gov.uk - FIRE0603: Primary fires fatalities and non-fatal casualties by item first ignited.

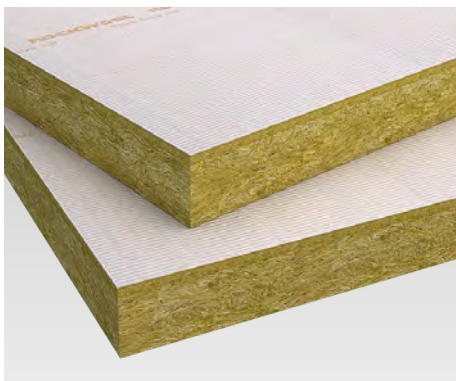

HardRock® Multi-Fix (DD)

HardRock® Multi-Fix (DD) is a BBA-approved stone wool insulation board faced with a mineral-coated white fleece, compatible with a wide range of adhered and mechanically-fixed waterproofing systems - including bitumen, single-ply, EPDM and liquid membranes, as well as green roof systems.

Lambda 0.039 W/mK

Pallet Size 1200 x 1000mm

Product Code	Thickness (mm)	Width (mm)	Length (mm)	Pieces/Pallet	Area/Pallet (m ²)	MOQ (Pallet)	List Price/m ²
138230	60	1000	1200	20	24.00	1	€40.24
133134	85	1000	1200	15	18.00	1	€51.35
132664	105	1000	1200	12	14.40	1	€61.36
138250	115	1000	1200	10	12.00	1	€67.41
133090	150	1000	1200	8	9.60	1	€84.18
136405	185	1000	1200	6	7.20	1	€103.37

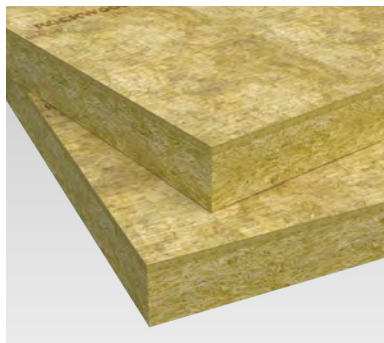

HardRock® Underlay Slab

Designed to be installed with HardRock® Multi-Fix DD, HardRock® Underlay forms a cost-effective base layer within multi-layer solutions. Manufactured from non-combustible stone wool, this robust product will contribute to the thermal, acoustic and fire performance of a flat roof system.

Lambda 0.039 W/mK

Pallet Size 1200 x 1000mm

Product Code	Thickness (mm)	Width (mm)	Length (mm)	Pieces/Pallet	Area/Pallet (m ²)	MOQ (Pallet)	List Price/m ²
155103	120	1000	1200	10	12.00	52	€68.63
138251	150	1000	1200	8	9.60	1	€69.20
216597	170	1000	1200	7	8.40	52	€84.18

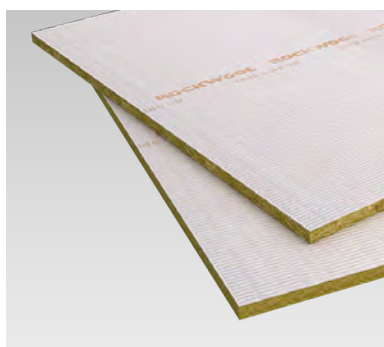

HardRock® Multi-Fix Recovery Board

HardRock® Multi-Fix Recovery Board has been purposely designed to simplify the repair and refurbishment of flat roof systems. The product can be used to isolate and prepare the surface of existing roof systems, providing a level surface for the installation of new waterproofing membranes.

HardRock® Multi-Fix Recovery Board is compatible with all commonly used flat roof membranes, including single ply, EPDM, bitumen and liquid membrane systems (including GRP).

Lambda 0.039 W/mK

Pallet Size 1200 x 1000mm

Product Code	Thickness (mm)	Width (mm)	Length (mm)	Pieces/Pallet	Area/Pallet (m ²)	MOQ (Pallet)	List Price/m ²
174879	30	1000	1200	40	48	1	€20.23

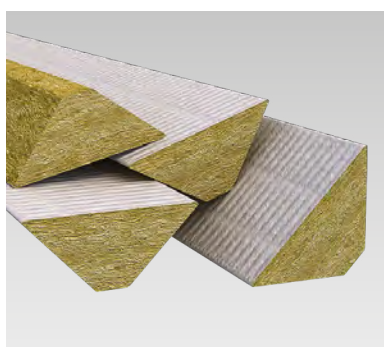

HardRock® Multi-Fix Angle Fillet

Manufactured from high density, fire resilient ROCKWOOL insulation, and faced with a white mineral-coated glass fibre fleece, HardRock® Multi-Fix Angle Fillets are designed to fully support bituminous waterproof membranes at 90° abutments.

The smooth transitions allow water to run off freely, as opposed to holding in corners, where it could potentially seep into the building and cause structural damage.

Pallet Size 1200 x 1200mm

Product Code	Thickness (mm)	Width (mm)	Length (mm)	Pieces/Box	MOQ (Box)	List Price/Linear m
292007	30	75	1200	75	1	€6.13



Orders for HardRock® UB34 & HardRock® Multi-Fix Angle Fillets cannot be used to contribute towards mixed loads. The lead times for these products can vary and will be confirmed on receipt of order. Additional carriage charges may be applied.

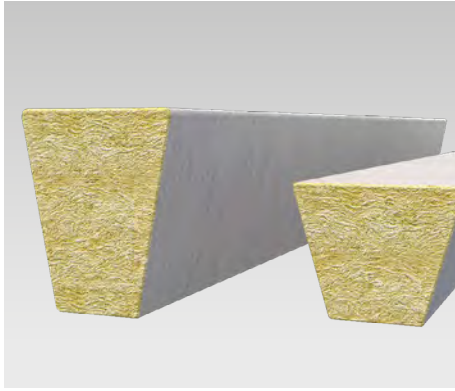

Acoustic Infill

ROCKWOOL® Acoustic Infills consist of a trapezoidal shaped ROCKWOOL insulation which can be engineered to suit all types of perforated metal roof deck profiles.

Acoustic Infills provide a combination of optimised density, fibre direction and excellent fit to deliver significant levels of sound absorption, designed and tested for use within ROCKWOOL HardRock® roof systems.

Acoustic Infills for different deck types, such as those from Joricide, Euro Clad, and Firth Steels, can be made to order subject to minimum order quantities. For further details please contact your local ROCKWOOL sales representative.

Tissue Faced White

Pallet Size 1200 x 1000mm

Product Code	Deck Type	Length (mm)	Major (mm)	Minor (mm)	Thickness (mm)	Pieces/Pallet	MOQ (Pallet)	List Price/Linear m
303802	TATA D32	1200	68	23	25	952	1	€6.55
303922	TATA D46	1200	116	63	40	340	1	€8.87
303994	TATA D60	1200	106	60	50	275	1	€9.42
303997	TATA D100	1200	120	59	95	140	1	€11.82
303999	TATA D137	1200	161	39	125	90	1	€15.35
304799	TATA D153	1200	157	36	150	81	1	€15.42
304800	TATA D158	1200	128	37	150	99	1	€15.42
304802	TATA D159	1200	138	34	150	99	1	€14.92
304804	TATA D200	1200	166	71	195	56	1	€20.07



Acoustic infill orders cannot be used to contribute towards mixed loads. Lead times for these products can vary and will be confirmed on receipt of order. Additional carriage charges may be applied.

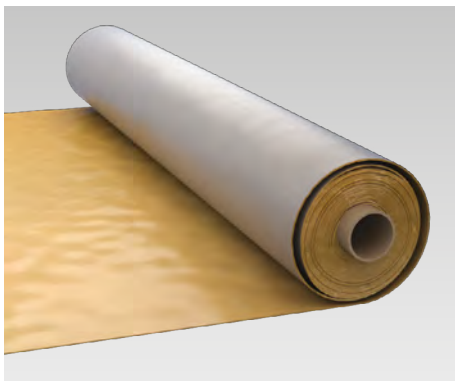

Acoustic Membrane

ROCKWOOL® Acoustic Membrane is a high performance, sound deadening, flexible polymeric mass layer which can be used to further enhance HardRock® Multi-Fix (DD) acoustic roof systems.

Pallet size 1220 x 1000mm

Product Code	Additional Information	Thickness (mm)	Width (mm)	Length (mm)	Area/Roll (m ²)	Roll/Pallet	Area/Pallet (m ²)	MOQ (Roll)	List Price/m ²
128098	5Kg Membrane	2.5	1220	6050	7.38	24	177.14	1	€55.97
128099	10Kg Membrane	5	1200	4000	4.8	21	100.80	1	€112.58

Flat roofs: The functional fifth façade

Mitigating fire risk above and below modern flat roofs.

Today's flat roofs are increasingly used as multifunctional spaces for social and practical applications, including solar energy installations.

This expanding remit, particularly in crowded urban areas, brings multifaceted challenges to specification and building design.

Learn to mitigate the risks.

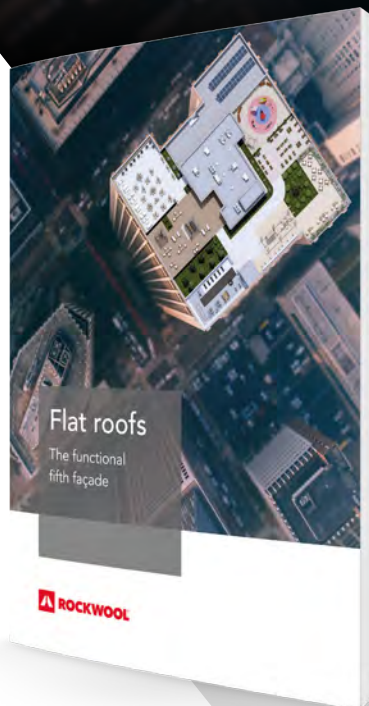

Download the
whitepaper:



[rockwool.com/uk/
functionalroofs](https://rockwool.com/uk/functionalroofs)



[X](#) [in](#) [f](#) [@](#) [▶](#)
rockwool.com/uk

[< Back to Contents Page](#)

T: 00 44 1656 868 400

29

Floor Solutions

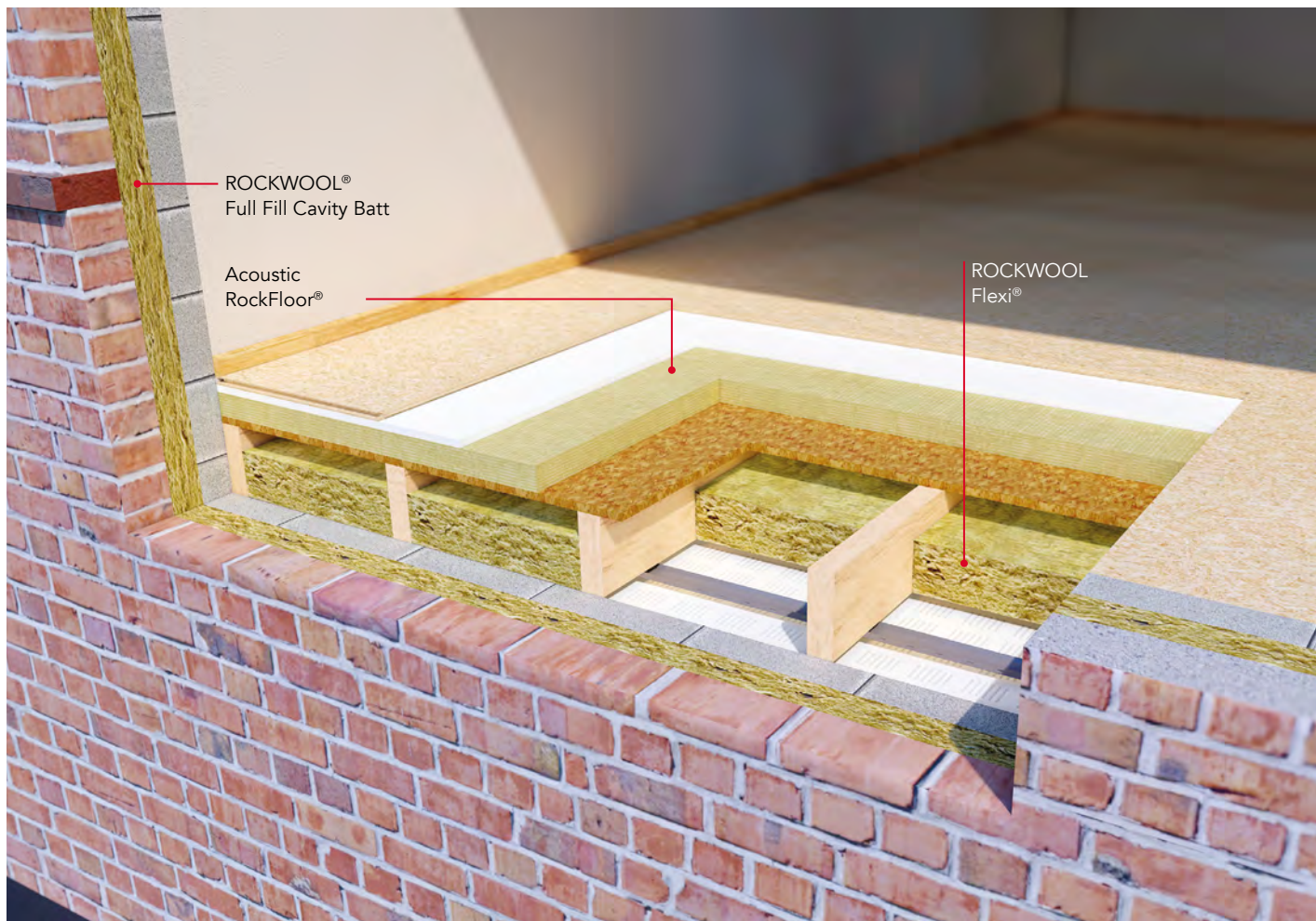

ROCKWOOL insulation offers solutions for all types of floor, including ground floors, separating floors and intermediate floors.

Energy efficiency and sound management are key to creating comfortable and healthy working and living environments. The thermal and acoustic performance of floor systems is an essential consideration when developing specifications for all building types.

Specifying Thermal RockFloor® within ground floor applications and Acoustic RockFloor® to separating floors ensures the right level of performance is delivered where it matters, creating comfortable indoor climates for building occupants.

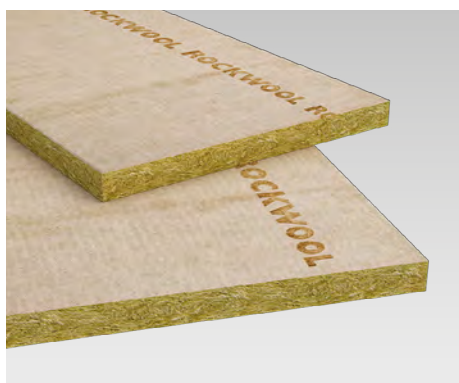

RockFloor®

RockFloor® solutions are split into two families; Thermal RockFloor®, designed for the thermal insulation of ground and separating floors, and Acoustic RockFloor®, designed to provide high levels of sound absorption in internal and separating floors.

The unique dual density structure of Thermal RockFloor® means the slabs are able to absorb sub-floor imperfections on one side, and provide a high level of compressive strength on the other. The slabs are also easy to handle and fit.

Acoustic RockFloor®

Pallet size 1200 x 1000mm

Product Code	Thickness (mm)	Width (mm)	Length (mm)	Boards/Pallet	Area/Pallet (m ²)	Made to Order	MOQ (Pallet)	List Price/m ²
122663	25	600	1000	96	57.60			€42.05
122664	30	600	1000	80	48.00			€50.61
122666	50	600	1000	48	28.80			€84.38

Thermal RockFloor®

Lambda 0.038 W/mK

Pallet size 1200 x 1000mm

Product Code	Thickness (mm)	Width (mm)	Length (mm)	Boards/Pallet	Area/Pallet (m ²)	Made to Order	MOQ (Pallet)	List Price/m ²
125051	50	600	1000	48	28.80			€54.48
125054	80	600	1000	30	18.00	•	16	€70.46
125056	100	600	1000	24	14.40			€92.69



Roll Products

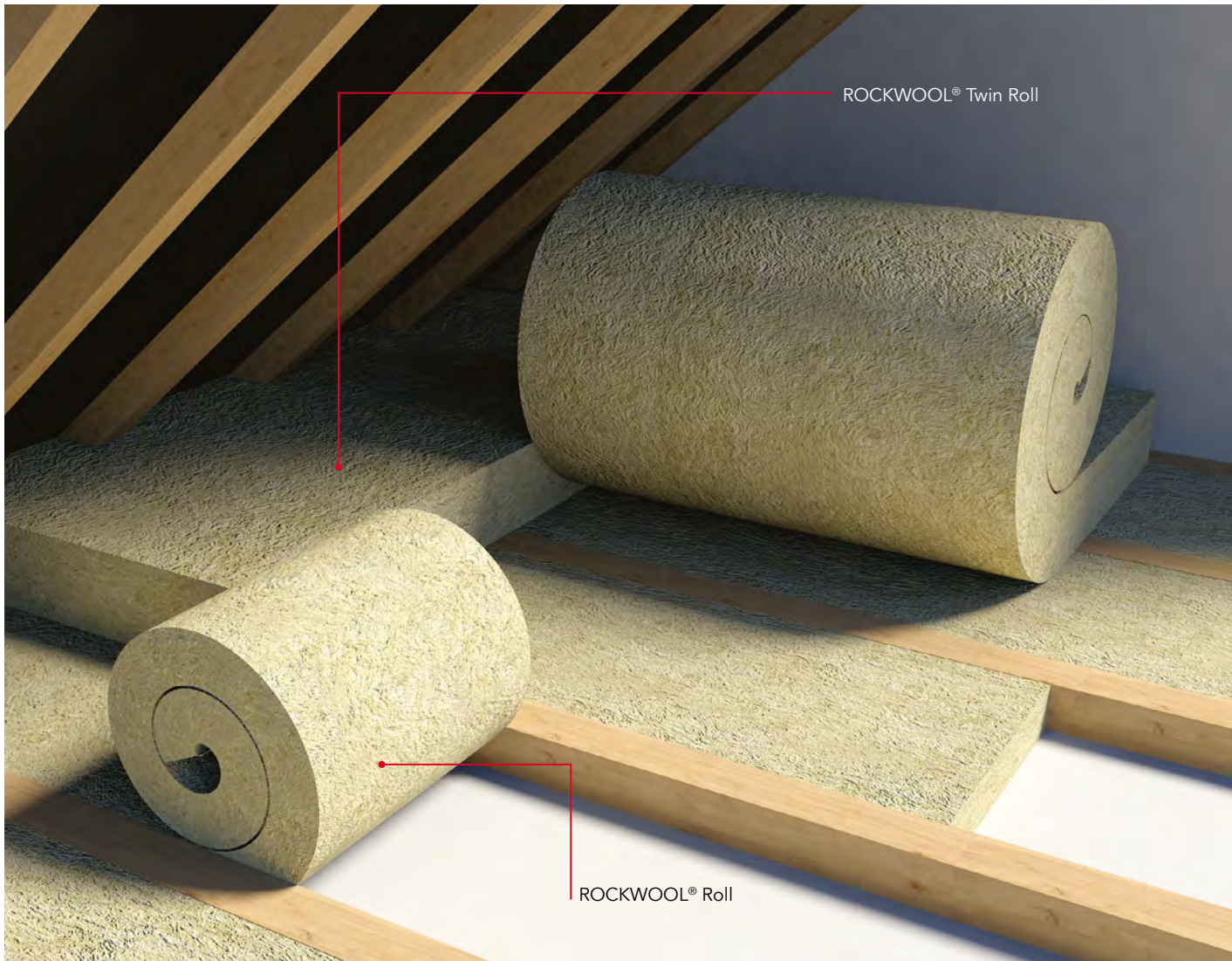

Installing the right insulation can go a long way to keeping homes warm throughout the winter months. According to the Energy Savings Trust, a quarter of heat is lost through the roof of an uninsulated home.

A well-insulated loft space can prevent heat escaping homes through the roof resulting in a warmer home. Energy-efficient homes tend to have reduced energy bills and a more comfortable living environment.

When choosing loft insulation, it is important to ensure the right thickness of insulation is installed. The current building guidelines recommend 300mm insulation thickness, but in many homes currently, there is as little as 100mm. This can be particularly true for older houses. Insulation performance plays an important role when choosing the right insulation, factors such as fire resistance and moisture repellence are often overlooked but can make a difference in the lifespan of the insulation material.

ROCKWOOL insulation is renowned for its excellent characteristics in these areas, making it an effective loft insulation solution for the lifetime of the building.

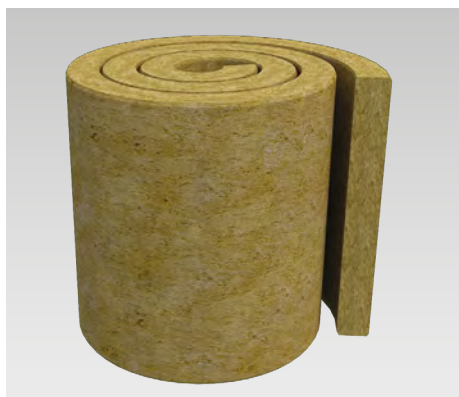

ROLL Products

ROCKWOOL® Twin Roll, Roll and Rollbatt products provide excellent medium density thermal and acoustic insulation. The products are suitable for a wide range of applications including roof spaces in all types of building and as an overlay for ceiling tiles in suspended ceilings.

ROCKWOOL® Roll products are all non-combustible (Euroclass A1).

Twin Roll

Lambda 0.044 W/mK

Pallet Size 1200 x 1200mm

Product Code	Thickness (mm)	Width (mm)	Length (mm)	Pieces/ Pack	Packs/ Pallet	Area/ Pallet (m ²)	List Price/m ²
125063	100	1200	2750	2	18	118.80	€13.52

Roll

Pallet Size 1200 x 1200mm

Product Code	Thickness (mm)	Width (mm)	Length (mm)	Pieces/ Pack	Packs/ Pallet	Area/ Pallet (m ²)	List Price/m ²
339822	150	1200	3200	1	18	69.12	€20.99

Rollbatt

Pallet Size 1200 x 1200mm

Product Code	Thickness (mm)	Width (mm)	Length (mm)	Pieces/ Pack	Packs/ Pallet	Area/ Pallet (m ²)	List Price/m ²
124625	100	400	4800	3	18	103.68	€13.62
124626	100	600	4800	2	18	103.68	€13.62
339692	150	400	3200	3	18	69.12	€20.99
339691	150	600	3200	2	18	69.12	€20.99

Slab Products



The ROCKWOOL Slab Insulation ranges provide excellent thermal, acoustic and fire insulation (Euroclass A1) for the general building market, in multiple applications including floors, walls and roofs.

ROCKWOOL slabs are easy to handle and install, are highly durable and do not slump. The Product ranges consist of high quality resin bonded slabs in a variety of thicknesses and densities.

The ROCKWOOL Slab Range is CE marked according to EN 13162:2012 +A1:2015.

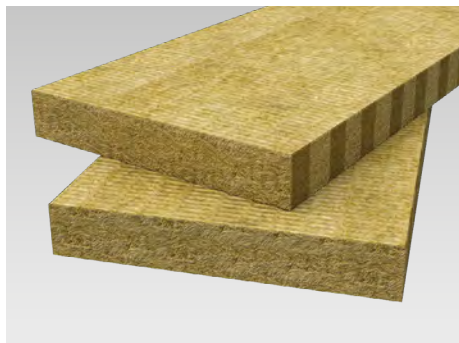

Flexi®

Flexi® is a multi-use, dual purpose thermal and acoustic insulation product with a unique flexible edge along one side. The patented flexible edge ensures a perfect fit is maintained between the product and its supporting framework for easy installation and optimum effectiveness.

Lambda 0.038 W/mK (50 - 120mm) - 0.035 W/mK (≥140mm)

Pallet Size 1200 x 1200mm

Product Code	Thickness (mm)	Width (mm)	Length (mm)	Pieces/ Pack	Area/ Pack (m ²)	Packs/ Pallet	Area/ Pallet (m ²)	Made to Order	MOQ (Pallet)	List Price/m ²
274366	50	400	1200	12	5.76	24	138.24			€11.78
274404	50	600	1200	12	8.64	16	138.24			€11.78
123320	60	600	1200	12	8.64	12	103.68			€14.40
123322	70	600	1200	8	5.76	16	92.16			€16.31
123324	90	600	1200	6	4.32	20	86.40			€20.55
123325	100	400	1200	6	2.88	30	86.40			€23.36
123326	100	600	1200	6	4.32	20	86.40			€23.36
123328	120	600	1200	6	4.32	16	69.12	•	22	€27.99
123329	140	400	1200	4	1.92	24	46.08			€32.77
123330	140	600	1200	4	2.88	16	46.08			€32.77
163833	180	600	1200	3	2.16	12	25.92			€42.13



RW Slab Range

The versatile ROCKWOOL RW slab range is used for thermal, acoustic and fire insulation in general building applications.

A range of alternative sizes and facings (tissue and foil) are available on request subject to minimum order quantities.

RWA45

Lambda 0.035 W/mK

Pallet Size 1200 x 1200mm

Product Code	Thickness (mm)	Width (mm)	Length (mm)	Pieces/ Pack	Area/ Pack (m ²)	Packs/ Pallet	Area/ Pallet (m ²)	Made to Order	MOQ (Pallet)	List Price/m ²
181173	25	600	1200	16	11.52	12	138.24			€6.03
181174	30	600	1200	12	8.64	16	138.24			€7.30
181175	40	600	1200	12	8.64	16	138.24			€9.74
181176	50	600	1200	9	6.48	16	103.68			€12.13
181177	60	600	1200	8	5.76	16	92.16			€14.61
209290	75	600	1200	6	4.32	20	86.40			€18.25
209274	100	600	1200	4	2.88	20	57.60			€24.12

RW3

Lambda 0.034 W/mK

Pallet size 1200 x 1200mm

	Product Code	Thickness (mm)	Width (mm)	Length (mm)	Pieces/ Pack	Area/ Pack (m ²)	Packs/ Pallet	Area/ Pallet (m ²)	Made to Order	MOQ (Pallet)	List Price/m ²
	181180	25	600	1200	16	11.52	12	138.24			€7.90
	181181	30	600	1200	15	10.80	12	129.60			€9.51
	181182	40	600	1200	10	7.20	12	86.40			€12.59
	181183	50	600	1200	8	5.76	12	69.12			€15.71
	181184	60	600	1200	6	4.32	12	51.84			€18.85
	181185	75	600	1200	6	4.32	12	51.84			€23.57
	237922	90	600	1200	5	3.60	12	43.20			€24.99
	181186	100	600	1200	4	2.88	12	34.56			€31.66
*	181188	50	600	1000	8	4.80	15	72.00	•	22	€18.73
□	181189	30	600	1000	10	6.00	20	120.00	•	22	€15.82
■	181244	100	600	1000	4	2.40	15	36.00	•	22	€46.54

KEY: * Black Tissue Faced □ White Tissue Faced ■ Foil Faced

RW4

Lambda 0.034 W/mK

Pallet size 2400 x 1200mm

Product Code	Thickness (mm)	Width (mm)	Length (mm)	Pieces/ Pack	Area/ Pack (m ²)	Packs/ Pallet	Area/ Pallet (m ²)	Made to Order	MOQ (Pallet)	List Price/m ²
181191	50	600	1200	6	4.32	16	69.12	•	22	€16.09
181192	75	600	1200	4	2.88	16	46.08	•	22	€24.00
181193	100	600	1200	3	2.16	16	34.56			€32.13

RW5

Lambda 0.034 W/mK

Pallet size 2400 x 1200mm

Product Code	Thickness (mm)	Width (mm)	Length (mm)	Pieces/ Pack	Area/ Pack (m ²)	Packs/ Pallet	Area/ Pallet (m ²)	Made to Order	MOQ (Pallet)	List Price/m ²
181194	25	600	1200	8	5.76	24	138.24			€11.79
181195	30	600	1200	8	5.76	20	115.20			€14.18
181197	50	600	1200	4	2.88	24	69.12			€23.82
181199	75	600	1200	3	2.16	20	43.20			€35.56
181200	100	600	1200	2	1.44	24	34.56			€47.26

Product Code	Thickness (mm)	Width (mm)	Length (mm)	Slabs/ Pallet	Area/ Pallet (m ²)	Made to Order	MOQ (Pallet)	List Price/m ²
181265	150	600	1200	32	23.04	•	22	€71.93

Why choose ROCKWOOL stone wool insulation?

At ROCKWOOL, we have been manufacturing for more than 40 years.

Our stone wool insulation is made from a natural and abundant material - volcanic rock.

This provides a unique combination of benefits that are the foundation of our business.



Fire resilience

Stone wool insulation can tolerate temperatures up to 1,000°C and will not burn.



Robustness

The dimensional stability of stone wool insulation means reliable, long-term performance.



Thermal properties

ROCKWOOL insulation provides thermal performance, reducing bills and enhancing indoor comfort.



Water repellence

Stone wool insulation is water resistant and can help to prevent damp and mould.



Acoustic capabilities

The structure and density of ROCKWOOL insulation means it traps sound waves and absorbs vibrations.



Circularity

Volcanic rock is one of the most abundant materials on the planet. Stone wool is both reusable and recyclable.



Fire Protection Solutions

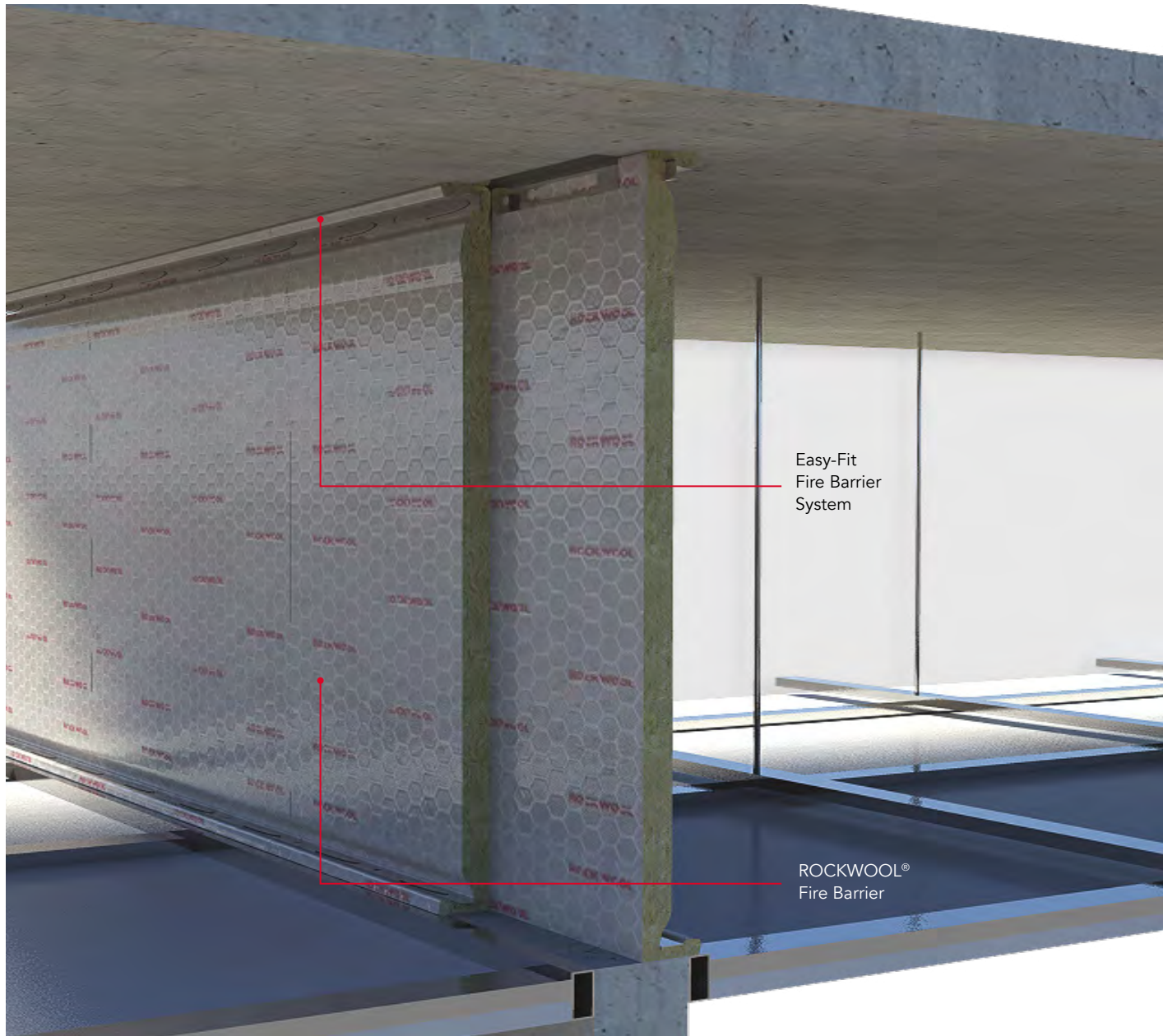

In the event of a fire, our tested fire protection solution slows the spread of the flames. ROCKWOOL stone wool does not produce any significant toxic smoke and also helps protect the building's load-bearing structure, protecting lives and investment.

By protecting the structural frame of the building from destruction by fire, it is possible to give occupants more time to escape, and to limit damage to the building.

ROCKWOOL insulation provides in-built fire protection in every slab, roll or panel, and because stone mineral wool can tolerate temperatures in excess of 1000°C it is the ideal material for fire protection.

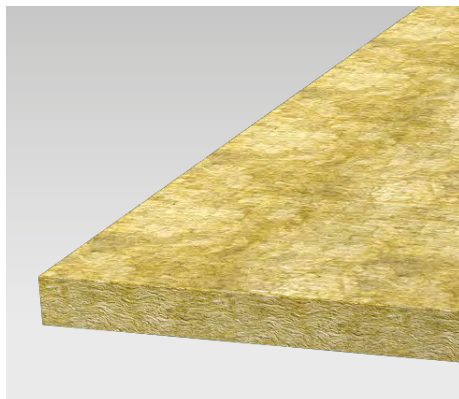

BeamClad®

BeamClad® provides fire protection for structural steel and cellular sections. They can be fitted in a variety of ways offering up to 4 hours fire protection and provide a complete 'tool box' of economical fire protection options for modern steel constructions.

Benefits:

- Up to 4 hours fire protection
- Variety of fixing methods
- No maintenance required
- Easy to repair

BeamClad®

Pallet size 2000 x 1200mm

Product Code	Additional Information	Thickness (mm)	Width (mm)	Length (mm)	Pieces/Pallet	Area/Pallet (m ²)	Made to Order	MOQ (Pallet)	List Price/m ²
122706	Plain	25	1200	2000	45	108.00			€38.05
122708	Plain	30	1200	2000	40	96.00	•	8	€53.90
122709	Plain	35	1200	2000	32	76.80	•	8	€63.78
122710	Plain	40	1200	2000	30	72.00			€71.83
122711	Plain	50	1200	2000	24	57.60	•	6	€89.72
122698	Foil Faced	25	1200	2000	45	108.00	•	4	€48.32
122699	Foil Faced	30	1200	2000	40	96.00	•	4	€64.18
122701	Foil Faced	40	1200	2000	30	72.00	•	4	€82.10
254656	Foil Faced	50	1200	2000	24	57.60	•	6	€99.94



FirePro® Glue

ROCKWOOL FirePro® Glue is a specially formulated water-based fire resistant adhesive for use within ROCKWOOL fire protection systems and also other suitable ROCKWOOL products where a fire resistant adhesive is needed.

Benefits:

- Up to 4 hours fire protection
- Listed on the LUL Product Register
- Easy to apply
- Can be use from 10°C upwards
- Cures in as little as 4 hours

Product Code	Tub Size (kg)	Tubs/Pallet	MOQ (Tub)	List Price/Tub
128034	17	48	1	€167.25

Product Code	Cartridge Size (ml)	Cartridges/(Pack)	MOQ (Pack)	List Price/Pack
276658	300	12	1	€130.42

Approximate coverage 10.2m²/tub subject to application thickness.

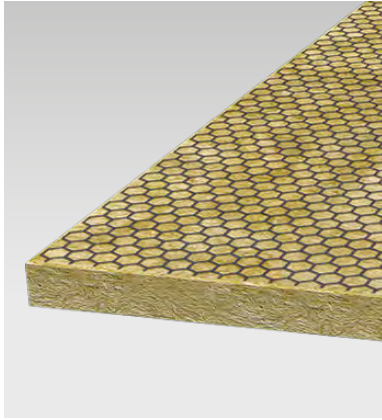

Fire Barrier System

Fire Barrier Systems offer labour-saving solutions to prevent the spread of fire and smoke within roof and ceiling voids.

The Fire Barrier System comprises the following products:

- Fire Barrier
- Fire Barrier Slab
- Easy Fit Fire Barrier System.

Options are available to provide up to 4 hours fire protection and fixings to a variety of substrates.

Benefits:

- Patented 'Quick Fit' support system allows cost effective installation of Fire Barriers with a fire rating of up to 60 minutes
- Ease of construction and installation reduces the risk of installation errors
- Extended drops easily catered for with system capable of maintaining its performance in void heights up to 10.5 metres

Fire Barrier

Pallet size 1200 x 1200mm

	Product Code	Thickness (mm)	Width (mm)	Length (mm)	Pieces/ Pack	Area/ Pack (m ²)	Packs/ Pallet	Area/ Pallet (m ²)	Made to Order	MOQ (Pallet)	List Price/m ²
P	317915	50	1000	3700	1	3.70	21	77.70			€38.63
P	317921	60	1000	3000	1	3.00	21	63.00			€46.45
F	317868	50	1000	3700	1	3.70	21	77.70			€49.36
F	317870	60	1000	3000	1	3.00	21	63.00			€53.36
FF	317898	50	1000	3700	1	3.70	21	77.70			€60.24
FF	317905	60	1000	3000	1	3.00	21	63.00	*	8	€61.71

KEY: P Plain (Wire Only) F Foil Faced 1 side, wire 1 side FF Foil Faced 2 sides, wire 1 side

Easy Fit Fire Barrier System

Product Code	Additional Information	Thickness (mm)	Width (mm)	Length (mm)	Pieces/ Pack	MOQ (Pack)	List Price/ Pack
128032	Angle Support	1.2	75	3000	10	1	€759.81
128033	Clamping Plate	1.2	40	3000	10	1	€422.64

Fire Barrier Slab

Pallet size 2000 x 1000mm

Product Code	Additional Information	Thickness (mm)	Width (mm)	Length (mm)	Pieces/ Pack	Area/ Pack (m ²)	Packs/ Pallet	Area/ Pallet (m ²)	List Price/m ²
181216	Foil faced 2 sides	100	666	1000	3	2.00	12	23.98	€110.42



Fire Barrier Angle Support and Clamping Plate



Fire Tube

Fire Tube is a rigid, pre-formed cylindrical section of ROCKWOOL insulation specially engineered to provide cellulosic fire protection to circular section structural steel, and to process sprinkler and service pipes. In addition to fire protection the Fire Tube provides a high degree of thermal and acoustic insulation.

Benefits:

- Range of wall thicknesses to accommodate specific steelwork, pipe and content fail temperatures Individually manufactured to fit pipe and CHS sizes up to 610mm outside diameter
- Includes a partially split hinge for easy installation
- Tested to BS EN 13381-4 for up to 180 minutes

To Suit Pipe O/D (mm)	List Price/linear metre by thickness										Length 1000mm	
	25mm Price		40mm Price		50mm Price		60mm Price		70mm Price			Made to Order
	Plain	Foil	Plain	Foil	Plain	Foil	Plain	Foil	Plain	Foil		
21	€32.93	€44.46	€53.78	€72.59								•
27	€35.86	€48.42	€56.36	€76.10	€83.68	€112.95						•
34	€38.51	€51.98	€61.39	€82.89	€88.93	€120.05				€158.52	€214.01	•
42	€42.78	€57.77	€65.11	€87.90	€90.26	€121.85	€151.88	€205.05	€161.86	€218.51		•
48	€47.14	€63.63	€67.88	€91.64	€95.03	€128.30	€158.60	€214.09	€172.34	€232.67		•
54	€49.62	€67.01	€73.75	€99.56	€104.17	€140.63	€163.43	€220.60	€176.89	€238.81		•
60	€52.62	€71.04	€77.91	€105.16	€106.84	€144.24	€168.34	€227.27	€185.36	€250.25		•
67	€56.90	€76.81	€84.68	€114.33	€114.45	€154.49	€174.07	€235.00	€197.61	€266.76		•
76	€60.23	€81.31	€87.18	€117.70	€116.67	€157.52	€176.88	€238.79	€206.97	€279.42		•
80	€64.26	€86.73	€91.94	€124.11	€122.93	€165.96	€185.43	€250.34	€211.39	€285.39		•
89	€66.14	€89.28	€95.03	€128.30	€145.28	€196.14	€188.37	€254.31	€220.67	€297.89		•
102	€66.72	€90.05	€115.59	€156.07	€152.02	€205.24	€200.80	€271.09	€256.47	€346.24		•
108	€85.00	€114.76	€119.20	€160.93	€160.95	€217.27	€218.27	€294.68	€260.84	€352.12		•
114	€87.77	€118.51	€123.17	€166.27	€161.29	€217.74	€224.63	€303.23	€266.47	€359.72		•
127	€95.26	€128.60	€132.18	€178.46	€171.04	€230.90	€242.61	€327.53	€289.31	€390.57		•
140	€102.17	€137.94	€140.20	€189.27	€181.12	€244.51	€258.65	€349.19	€296.04	€399.68		•
159	€115.01	€155.25	€155.39	€209.76	€206.03	€278.15	€267.19	€360.68	€312.52	€421.90		•
169	€123.16	€166.25	€165.74	€223.78	€210.39	€284.02	€275.82	€372.35	€321.42	€433.90		•
194	€144.46	€195.03	€193.15	€260.72	€243.10	€328.20	€314.99	€425.23	€377.72	€509.90		•
205	€152.09	€205.30	€201.52	€272.05	€255.88	€345.45	€338.15	€456.50	€380.36	€513.50		•
219	€160.07	€216.09	€210.18	€283.75	€263.46	€355.67	€341.30	€460.77	€393.58	€531.33		•
230	€170.86	€230.65	€217.87	€294.11	€272.71	€368.17	€361.92	€488.59	€424.09	€572.51		•
253	€179.88	€242.81	€234.56	€316.67	€300.15	€405.19	€384.12	€518.55	€442.14	€596.90		•
273	€192.20	€259.47	€249.04	€336.20	€308.62	€416.63	€393.58	€531.33	€450.77	€608.54		•
324	€221.95	€299.61	€285.62	€385.61	€350.20	€472.76	€457.40	€617.49	€505.15	€681.94		•
356			€316.53	€427.31	€387.12	€522.61	€563.48	€760.71	€621.84	€839.49		•

Alternative thicknesses can be made to order.

The packaging and splitting of these items varies according to the size of the section. These sections will be supplied either pre-split or unsplit depending on the size required. Some sizes are boxed and some are supplied as singles wrapped in polythene.

The lead times for these products can vary and will be confirmed on receipt of order.

For details on thicknesses made to order, or on the specific packaging and splitting of the pipe required, please contact your local ROCKWOOL representative.



Soffit Slab

Soffit Slab provides cost effective fire resistance and thermal insulation to concrete soffits and consists of a rigid ROCKWOOL insulation board in various thicknesses. It is available in black or white tissue facing, aluminium foil facing and also a non-combustible high-impact board.

Benefits:

- Excellent thermal and acoustic performance
- Cost effective and easy to install, simply butt together at joints
- Water repellent
- Easily cut to accommodate services

Soffit Slab

Pallet size 2000 x 1200mm

Product Code	Additional Information	Thickness (mm)	Width (mm)	Length (mm)	Pieces/Pallet	Area/Pallet (m ²)	Made to Order	MOQ (Pallet)	List Price/m ²
272234	Plain	50	600	1000	96	57.6	•	8	€33.37
124809	Plain	130	600	1000	36	21.60			€62.43
124813	Plain	160	600	1000	32	19.20			€76.89
124802	Foil faced	130	600	1000	36	21.60			€69.56
124804	Foil faced	145	600	1000	32	19.20	•	14	€77.91
124806	Foil faced	160	600	1000	32	19.20	•	14	€85.10
124816	Tissue faced (black)	130	600	1000	36	21.60	•	12	€67.32
239238	Tissue faced (black)	160	600	1000	32	19.20	•	14	€84.77
124822	Tissue faced (white)	130	600	1000	36	21.60	•	12	€67.32

High-Impact Soffit Slab

Pallet size 2400 x 1200mm

Product Code	Additional Information	Thickness (mm)	Width (mm)	Length (mm)	Pieces/Pallet	Area/Pallet (m ²)	Made to Order	MOQ (Pallet)	List Price/m ²
255151	6mm High impact facing	136	600	1200	32	23.04	•	1	€144.37
129544	6mm High impact facing	166	600	1200	24	17.28	•	1	€165.06



Soffit Slab - High Impact orders cannot be used to contribute towards mixed loads. The lead times for these products can vary and will be confirmed on receipt of order. Contact Customer Services for more information.

Introducing FirePro® Silicone X



FirePro® Silicone X is a fire resistant silicone sealant which offers:

- A linear joint seal for walls and floors
- Suitable for internal and external applications
- CE marked solution
- Up to four hours fire integrity*
- Movement capacity of $\leq 7.5\%$
- Tested compatibility with multiple substrates

All packaged in a 30% recycled cartridge.

**Subject to the application.*

Find out more



[rockwool.com/uk/
silicone-x](https://rockwool.com/uk/silicone-x)



www.rockwool.com/uk

Fire Stopping Solutions



Fire Stopping solutions ensure that the fire resistance of protected walls, floors and roofs are never compromised by services or voids.

To stop fire spreading, UK Building Regulations insist on effective compartmentation, where fire, smoke and gases must be kept for as long as possible where they have originated. Our range of firestopping products ensure that cables, pipes, trunking, or ductwork, or the voids that they pass through, don't provide the weak link through which fire can spread.

Our comprehensive range of Penetration seals, Cavity barriers, Cavity fire stops and linear joint seals are listed in this section and suitable for most applications. However, if your requirement is a little out of the ordinary, contact your local ROCKWOOL representative, you can get their details at: www.rockwool.com/uk/contact-us/

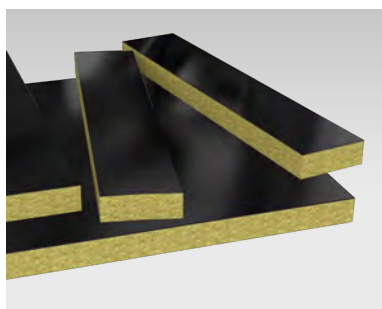

FirePro® SP FireStop EN

FirePro® SP FireStop EN comprises of both a medium density stone wool slab and a high emissivity black aluminium foil on both sides and is supplied in two thickness options depending on the fire rating required.

FirePro® SP FireStop EN has been tested in accordance with BS EN 1366-4:2021 and is suitable for use as a linear cavity firestop in both vertical and horizontal orientations.

Benefits:

- Tested against an SFS substrate both horizontally and vertically
- Up to EI 120 in cavities up to 600mm*
- Resists the passage of smoke - black aluminium foil on both sides

SP FireStop EN Slab

Pallet size 2000 x 1200mm

Product Code	Fire Rating (Up to Mins)	Thickness (mm)	Width (mm)	Length (mm)	Pieces/Pallet	Area/Pallet (m ²)	MOQ (Pallet)	List Price/m ²
336804	60	75	1000	1200	32	38.4	1	€229.71
333802	120	90	1000	1200	24	28.8	1	€243.57

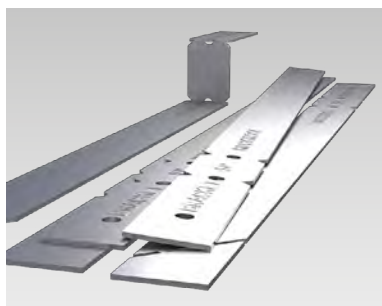

SP FireStop Fixing Brackets

ROCKWOOL SP Fixing Brackets are supplied in three standard sizes; SP/S (small), SP/L (large) and *SP/XL for cavity widths up to 600mm. The brackets are supplied in cardboard boxes of 50 pieces, flat packed and designed to be easily re-profiled by hand on site.

**SP/XL brackets are designed for use with SP FireStop Plus Slab® for 2 hours fire resistance in cavities up to 600mm.*

SP FireStop Fixing Brackets

Product Code	Additional Information	Cavity Size (Up to mm)	Unit	Pieces/Pack	MOQ (Pack)	List Price/Pack
128709	SP/S (small)	100	Pack	50	1	€233.24
128710	SP/L (large)	400	Pack	50	1	€272.21
259890	SP/XL (extra large)	600	Pack	50	1	€475.67

SP FireStop Fixing Brackets - Stainless Steel

Product Code	Additional Information	Cavity Size (Up to mm)	Unit	Pieces/Pack	MOQ (Pack)	List Price/Pack
318285	SP Small SS	100	Pack	50	1	€307.17
318287	SP Large SS	400	Pack	50	1	€596.32
318289	SP Xlarge SS	600	Pack	50	1	€893.85

Carriage charges for SP Firestop Fixing Brackets - Stainless Steel may apply and will be confirmed on receipt of order.



Thermal Cavity Barriers

Thermal Cavity Barriers - TCB (Thermal Cavity Barrier) and PWCB (Party Wall Cavity Barrier) - have been developed to exceed minimum building regulation requirements for fire resistance within concealed wall cavities.

Tested and assessed for integrity and insulation to BS 476-20 and EN 1366-4:2006+A1 2010.

Benefits:

- Performance is not affected by movement in the building, shrinkage or thermal change
- Durable
- Can be used vertically or horizontally
- Easy to install

In bags within a box on a pallet 1300 x 1200mm. Full pallet quantities only, no mixed pallets

Product Code	To Suit Cavity (mm)	Thickness (mm)	Width (mm)	Length (mm)	Pieces/ Bag	LM/ Bag	Bags/ Pallet	LM/ Pallet	Made to Order	MOQ (Pallet)	List Price/ Linear m
318157	50-55	65	65	1200	31	37.20	6	223.20	•	1	€3.89
318162	56-65	75	75	1200	28	33.60	6	201.60	•	1	€5.22
318169	76-80	90	90	1200	20	24.00	6	144.00	•	1	€7.58
318172	91-100	110	110	1200	14	16.80	6	100.80	•	1	€9.62
164551	101-110	120	120	1200	15	18.00	5	90.00	•	1	€11.14
164564	111-120	130	130	1200	12	14.40	5	72.00	•	1	€12.63
318173	121-130	140	140	1200	10	12.00	5	60.00	•	1	€13.82
318174	131-140	150	150	1200	9	10.80	5	54.00	•	1	€16.72
318175	141-150	160	160	1200	8	9.60	5	48.00	•	1	€18.24
285504	150-155	170	150	1200	6	7.20	16	115.20	•	1	€26.19
302465	155-160	175	150	1200	6	7.20	16	115.20	•	1	€26.26
292612	160-165	180	150	1200	6	7.20	16	115.20	•	1	€27.03
283063	165-170	185	150	1200	6	7.20	16	115.20	•	1	€27.21
292614	170-175	190	150	1200	6	7.20	16	115.20	•	1	€27.47
301323	175-180	195	150	1200	6	7.20	15	108.00	•	1	€27.86
293169	180-185	200	150	1200	6	7.20	15	108.00	•	1	€28.32
295196	185-190	205	150	1200	4	4.80	22	105.60	•	1	€29.26
291760	190-200	210	150	1200	4	4.80	20	96.00	•	1	€30.28



Party Wall Cavity Barriers

The ROCKWOOL Party Wall Cavity Barrier have been developed to exceed minimum building regulation requirements for fire resistance within concealed wall cavities.

Benefits:

- Performance is not affected by movement in the building, shrinkage or thermal change

In bags within a box on a pallet 1300 x 1200mm. Full pallet quantities only, no mixed pallets

Product Code	To Suit Cavity (mm)	Thickness (mm)	Width (mm)	Length (mm)	Pieces/ Bag	LM/ Bag	Bags/ Pallet	LM/ Pallet	Made to Order	MOQ (Pallet)	List Price/ Linear m
318187	50-55	65	200	1200	12	14.40	6	86.4	•	1	€25.41
318193	76-80	90	200	1200	9	10.80	6	64.8	•	1	€35.81
318195	91-100	110	200	1200	7	8.40	6	50.4	•	1	€37.18
164646	101-110	120	200	1200	9	10.80	5	54	•	1	€39.47
164648	111-120	130	200	1200	8	9.60	5	48	•	1	€40.67
164650	121-130	140	200	1200	7	8.40	5	42	•	1	€42.36
318196	131-140	150	200	1200	7	8.40	5	42	•	1	€46.28
164657	141-150	160	200	1200	6	7.20	5	36	•	1	€49.22

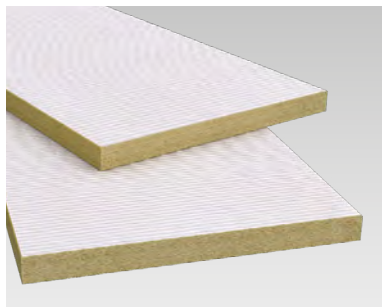

FirePro® Ablative Coated Batt

Ablative Coated Batt acts as an air seal barrier to reinstate the fire resistance and acoustic performances of concrete floors, masonry walls and dry wall systems, following the creation of voids for the passage of services.

Benefits:

- Up to 4 hours* fire performance
- No maintenance required
- Lightweight and simple to install
- Tested for airtightness

*Subject to the application.

Pallet size 1200 x 1200mm

Product Code	Thickness (mm)	Width (mm)	Length (mm)	Pieces/Pallet	Area/Pallet (m ²)	List Price/Batt
123094	50	600	1200	48	34.56	€26.41
123096	60	600	1200	40	28.80	€28.57



FirePro® Ablative Liquid

Ablative Coating is used to further improve the fire resistant properties of ROCKWOOL stone wool slabs. The ablative nature of the coating resists the risk of flame spreading and forms an insulated char which protects the stone wool slab. Ablative Coating is used within the manufacturing process of the ROCKWOOL Ablative Coated Batts and is available separately to enable any site repairs.

Product Code	Additional Information	Tub Size (Litre)	Unit	MOQ (Tub)	List Price/Tub
128085	Ablative Liquid	5	Tub	1	€52.30

For coverage details, please refer to our Technical Data Sheet.



FirePro® Acoustic Intumescent Sealant

Acoustic Intumescent Sealant seals joints and service penetrations within walls, partitions, fire rated door frames and glazing systems. It can also be used to seal joints within party walls to provide an acoustic seal.

Tested to BS EN 1366-4 as a linear fire-stop and to BS EN 1366-3 within penetration seals.

Benefits:

- Up to 4 hours* fire performance
- No maintenance required
- Lightweight and simple to install
- Tested for airtightness

*Subject to the application.

Pallet size 1200 x 1200mm

Product Code	Additional Information	Cartridge Size (ml)	Tub Size (kg)	Unit	Units/Box	Boxes/Pallet	MOQ	Unit List Price
212902	Sealant	310		Box	25	64	1 Box	€88.61/Box
241969	Sealant	600		Sausage	12	65	1 Box	€95.26/Box
128091	Trowel Grade		5	Tub		54*	1 Tub	€68.36/Tub

*The figure quoted is for units/tubs per pallet. For coverage details, please refer to our Technical Data Sheet.



Ablative Coated Batt will be shipped as part of full loads and subject to the delivery conditions detailed on pages 7 and 8. All other ROCKWOOL Fire Stopping products are dispatched via a courier and not shipped as part of full loads, as such these products will incur a carriage charge. For further details please contact ROCKWOOL Customer Support Centre.



FirePro® Silicone X

Supplied in 310ml cartridges, FirePro® Silicone X is a fire resistance silicone sealant designed for use as a linear joint seal within construction joints of walls and floors. Silicone X is white in colour and suitable for construction joints of up to 60mm.

Benefits:

- Suitable for internal and external use
- Can provide a cold smoke seal
- Tested with multiple substrates
- Cartridges contain 30% recycled plastic

Product Code	Additional Information	Cartridge Size (ml)	Cartridges/ Box	MOQ (Box)	List Price/ Cartridge
322075	White	310	25	1	€20.62

For coverage details, please refer to our Technical Data Sheet.



FirePro® FireStop Compound

FireStop Compound provides a fire resisting seal around service penetrations within fire rated walls and floors. Tested to BS476:Part 20 1987, FireStop Compound provides up to 6 hours* fire protection.

Benefits:

- Provides up to 6 hours* fire protection
- No smoke emission
- No maintenance required
- Load bearing

*Subject to the application.

Product Code	Bag Size (kg)	MOQ (Bag)	List Price/ Bag
128059	22	1	€72.78

For coverage details, please refer to our Technical Data Sheet.



FirePro® High Strength FireStop Compound

ROCKWOOL FirePro® HS FireStop Compound is designed to provide a fire-resisting seal around service penetrations in both fire rated wall and floor applications.

Tested to BS EN 1366:Part 3 HS FireStop compound provides up to 4 hours* fire resistance.

Benefits:

- High load-bearing capacity
- Suitable with multiple service penetrations
- Can be formed into blocks
- Effective smoke and acoustic barrier

*Subject to the application.

Product Code	Bag Size (kg)	Bags/ Pallet	MOQ (Pallet)	List Price/ Bag
260505	20	50	1	€111.43



The ROCKWOOL Fire Stopping products on this page are dispatched via a courier and not shipped as part of full loads, as such these products will incur a carriage charge. For further details please contact ROCKWOOL Customer Support Centre.



FirePro® High Expansion Intumescent Sealant

High Expansion Intumescent Sealant is an easy to apply water-based acrylic emulsion sealant containing graphite. It expands at temperatures above 135°C sealing around various penetrations and services to prevent the passage of smoke and flames.

Benefits:

- Flexible and durable
- Used on combustible and non-combustible pipes
- Up to 4 hours* fire protection
- Suitable for cables (single cables or bunches of cables)

*Subject to the application.

Product Code	Additional Information	Cartridge Size (ml)	Cartridges/Box	MOQ (Box)	List Price/Cartridge
128086	Grey	310	25	1	€30.40

For coverage details, please refer to our Technical Data Sheet.

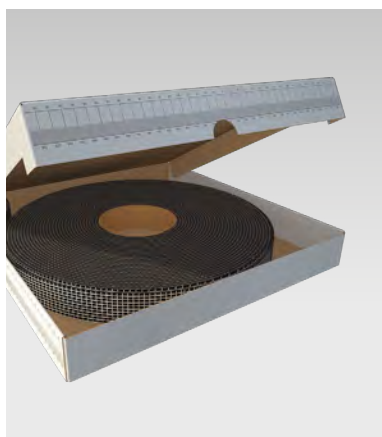

FirePro® Intumescent Pipewrap Roll

FirePro® Intumescent Pipewrap Roll offers a simple and more economical alternative to FireStop Collars and avoids the need to carry a wide range of individually sized Intumescent pipe wraps. Intumescent Pipewrap Roll is suitable for firestopping a variety of combustible pipes and metallic pipes insulated with combustible insulation in both walls and floors.

Benefits:

- Simple to Install
- No mechanical fixings required
- Water resistant
- Maintenance-free
- Supplied as a 25m long roll in box dispenser
- Available to suit pipes up to 200mm O/D
- Comprehensively tested
- Available from stock

Product Code	Roll Size (m)	Rolls/Box	MOQ (Box)	List Price/Box
234505	25	1	1	€608.14



FirePro® SpeedSeal

FirePro® SpeedSeal is a putty-based penetration sealing device for small cables and conduits in flexible and rigid walls. Available in 60mm and 100mm diameter disc's, tested to EN 1366-3.

Benefits:

- Easy & Quick to Install
- Up to EI 60 fire resistance
- 2 different size combinations to cover most small openings

Product Code	To Suit Service Opening	Diameter (mm)	Fire Rating (Hours)	Pieces/Box	MOQ (Box)	List Price/Box
299522	25mm x 25mm	60	1	20	1	€91.90
299526	50mm x 50mm	100	1	20	1	€119.28



FirePro® Insulated Fire Sleeves

Insulated Fire Sleeves are made up of a unique combination of stone wool and graphite intumescent; as a result they provide both thermal and fire insulation.

When exposed to fire they expand sealing gaps between the sleeve and the surrounding construction/pipework.

Benefits:

- Provides up to 2 hours* fire resistance
- Maintains pipe insulation at penetration points
- Supplied with integral vapour barrier
- No mastic or ancillaries required
- Excellent thermal and acoustic insulation

*Subject to the application.

Length 300mm

Product Code	Nominal O/D (mm)	Thickness (mm)	Made to Order	MOQ (Each)	List Price/ Each
128109	17	25	•	1	€93.65
128110	21	25	•	1	€96.88
128101	27	25	•	1	€106.39
128102	34	25	•	1	€107.83
128103	42	25	•	1	€114.90
128111	48	25	•	1	€118.74
128112	54	25	•	1	€115.94
128113	60	25	•	1	€122.11
128114	67	25	•	1	€125.67
128115	76	25	•	1	€130.99
128105	80	25	•	1	€134.99
128106	89	25	•	1	€149.10
128116	102	25	•	1	€155.71
128107	108	25	•	1	€160.04
128108	114	25	•	1	€170.71
128117	127	25	•	1	€182.45
128118	140	25	•	1	€191.27
128119	160	25	•	1	€213.03
128120	169	25	•	1	€215.70

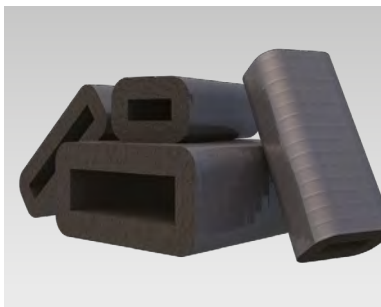

FirePro® Insulated Fire Duct Sleeve

Insulated Fire Sleeves to be cut to length to suit penetration (minimum length 60mm). Other sizes are available.

Length 180mm

Product Code	Width (mm)	Height (mm)	Made to Order	MOQ (Each)	List Price/ Each
223687	110	54	•	1	€90.84
223688	204	60	•	1	€120.98
294019	220	90	•	1	€181.47



Many of the products available from the FirePro® range are dispatched via a courier and therefore not shipped as part of a full or mixed load, as such, these products may incur additional carriage charges. For further details please contact the ROCKWOOL Customer Support Centre.



FirePro® Intumescent Pillow CE

FirePro® Intumescent Pillows CE are available in various sizes for packing into void spaces around services. Simple to install they are an ideal solution when installing additional services as they are easy to remove and reinstate.

Intumescent Pillows CE can be installed within rigid wall and rigid floor constructions. Intumescent Pillows CE are designed to create a temporary or permanent fire seal around services to maintain continuity of fire performance of compartment walls and floors.

Benefits:

- High performance intumescent
- Up to E120* fire resistance
- Easy to install, remove and reinstate
- Suitable for flexible wall and rigid wall/floor constructions
- Maintenance free
- Dry system

**Subject to the application.*

Product Code	Thickness (mm)	Width (mm)	Length (mm)	MOQ (Pillow)	List Price/ Pillow
301310	20	50	330	1	€21.09
301311	25	200	330	1	€28.76
301313	45	200	330	1	€32.80



FirePro® Intumescent Putty Pads

Intumescent Putty Pads have been developed for use in plasterboard partitions that have been partially penetrated by electrical socket boxes. They have been designed to maintain acoustic integrity and fire resistance.

Available for internal and external sockets in single and double gang boxes.

Benefits:

- Pre-cut cross shape ensures simple and easy installation
- Low smoke emission
- Internal Putty Pads reduce noise transfer
- Remains malleable

Product Code	Additional Information	Pad/ Box	MOQ (Each)	List Price/ Each
128092	Internal Single	20	1	€14.19
128093	Internal Double	20	1	€20.47



FirePro® Intumescent Pipe Wrap CE

FirePro® Intumescent Pipe Wraps CE are supplied in lengths to suit various pipe diameters designed to protect both plastic pipework and electrical trunking in fire rated walls and floors, making them a highly adaptable product for many construction projects.

Manufactured from layers of a graphite-based intumescent sheet encased in a polythene sheath, this design is able to fit most trunking sizes with the product wrapped around the outside of the pipework and fixed in places with self-adhesive strips.

Benefits:

- High performance intumescent
- Up to EI120* fire resistance
- Easy to install
- Tested in conjunction with Ablative Coated Batt seals
- Maintenance free
- Dry system

**Subject to the application.*

Product Code	Nominal O/D (mm)	MOQ (Each)	List Price/ Each
302323	40mm	1	€8.86
302326	55mm	1	€11.62
302327	63mm	1	€12.48
302328	75mm	1	€13.82
302329	82mm	1	€17.35
302330	90mm	1	€18.51
302331	110mm	1	€21.27
302332	125mm	1	€28.66
302333	160mm	1	€51.47
302334	200mm	1	€64.34



The ROCKWOOL Fire Stopping products on pages 46 and 47 are dispatched via a courier and not shipped as part of full or mixed loads, as such these products may incur a carriage charge. For further details please contact ROCKWOOL Customer Support Centre.



Linear Firestops

Linear Firestops provide firestopping at the junctions of compartment walls and floors. Tested to BS476:Part 20, they provide up to 4 hours* fire protection, fitted as rectangular pieces that tightly butt joint and must be compressed by at least 5% in thickness to ensure a secure fit.

Benefits:

- Provides up to 4 hours* fire stopping
- Suitable for all walls from 400 kg/m³
- Available in small quantities

*Subject to the application.

Width (mm)	List Price/linear metre by thickness						Length 1000mm
	15mm Price	25mm Price	30mm Price	40mm Price	50mm Price	60mm Price	Made to Order
75	€2.91	€4.96	€5.34	€7.07	€8.93	€10.73	•
100	€3.42	€5.70	€6.19	€8.22	€10.35	€12.86	•
120	€3.56	€6.05	€6.51	€8.72	€11.02	€13.22	•
140	€4.18	€7.07	€7.63	€10.09	€11.56	€13.82	•
150	€4.32	€7.23	€7.74	€10.13	€12.83	€15.35	•
160	€4.44	€7.40	€7.99	€10.65	€13.51	€16.09	•
170	€4.60	€7.80	€8.42	€11.15	€14.17	€16.96	•
180	€4.90	€8.17	€8.82	€11.77	€14.87	€17.76	•
190	€5.08	€8.57	€9.29	€12.31	€15.67	€18.68	•
200	€5.43	€9.10	€9.85	€12.98	€16.54	€19.79	•

In addition to the sizes shown ROCKWOOL manufacture a wide range of linear and trapezoidal firestop pieces to suit most applications. Linear Firestops will incur additional carriage charges, for further information please contact the ROCKWOOL Customer Support Centre.

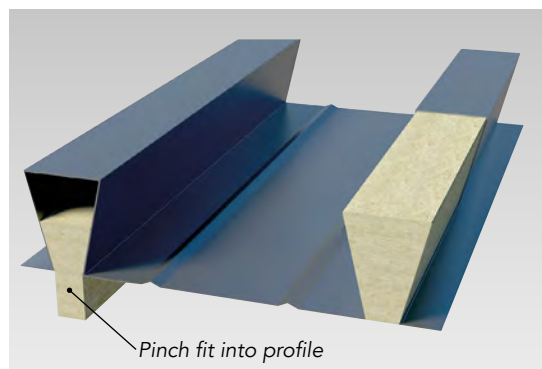

Dovetail Infill

ROCKWOOL Dovetail Infills are made from medium density non combustible stone wool. Designed to allow adequate compression for 'pinch fit' into the profile yet it retains the necessary lateral stiffness to aid installation.

Deck profile to be named at time of order.

Length 300mm

Product Code	To Suit Deck Manufacturer	To Suit Profile	Major (mm)	Minor (mm)	Height (mm)	Made to Order	List Price/ Each
244917	Kingspan	MD50	40	15	50	•	€4.20
244643	Kingspan	MD60	53	50	9	•	€2.91
253346	Kingspan	MD80	53	50	9	•	€3.53
298716	NSD	MF55	41	17	55	•	€4.20
TBC	NSD	MF60	45	45	15	•	€3.53
306642	Richard Lees	Superib	40	15	51	•	€3.53
TBC	Richard Lees	ED60	48	42	10	•	€3.53
289581	SMD	R51+	40	13	52	•	€4.20
289111	TATA	CF51+	38	15	51	•	€4.20
256950	TATA	CF60	50	47	15	•	€3.53
189784	TATA	CF80	50	47	15	•	€3.53

Dovetail Infills will incur additional carriage charges, for further information please contact the ROCKWOOL Customer Support Centre.

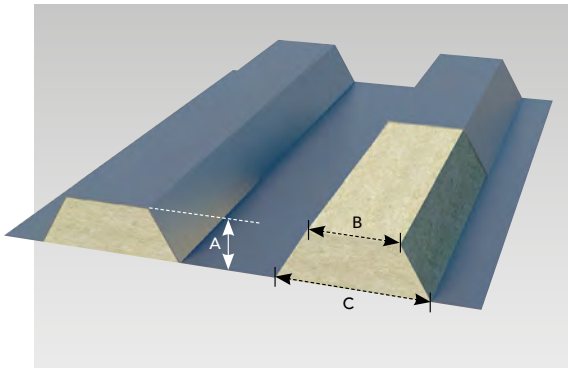

Trapezoidal Firestops

Trapezoidal Firestops prevent the passage of fire and smoke in the deck at the junction of compartment walls and floors. Manufactured slightly oversized to the deck profile ensure tight gap free fit.

Deck profile to be named at the time of order. alternatively, if deck brand is unknown measurements detailed on the left must be provided.

Length 1000mm

Product Code	To Suit Deck Manufacturer	To Suit Profile	Height (A) (mm)	Minor (B) (mm)	Major (C) (mm)	Made to Order	List Price/ Each
189777	Kingspan	MD60	61	142	213	•	€16.29
189778	Kingspan	MD80	80.5	131	198	•	€22.44
254420	NSD	MF60	60	130	175	•	€18.41
240887	NSD	MF80	80	130	175	•	€23.10
222626	Richard Lees	Ribdeck S60	60	130.7	180	•	€11.64
TBC	Richard Lees	E60	60	153	223	•	€18.41
283236	Richard Lees	RD80	80	115	180	•	€22.44
253757	SMD	TR60+	60	158	200	•	€18.41
240402	SMD	TR80+	80	137	178	•	€22.44
238396	TATA	CF60	60	131	180	•	€18.41
189782	TATA	CF80	80	150	180	•	€22.44
241426	TATA	D35	35	75	115	•	€10.98
263529	TATA	D46	46	105	158	•	€16.97
245632	TATA	D60	60	90	136	•	€16.29
189805	TATA	D100	100	109	170.3	•	€30.40
263918	TATA	D135	137	145	267	•	€45.86
189807	TATA	D153	153	119	240	•	€46.97
274959	TATA	D159	159	108	212	•	€46.97

Linear and Trapezoidal Firestop orders cannot be used to contribute towards mixed loads.

The lead times for these products can vary and will be confirmed on receipt of order.

Trapezoidal Firestops will incur additional carriage charges, for further information please contact the ROCKWOOL Customer Support Centre.

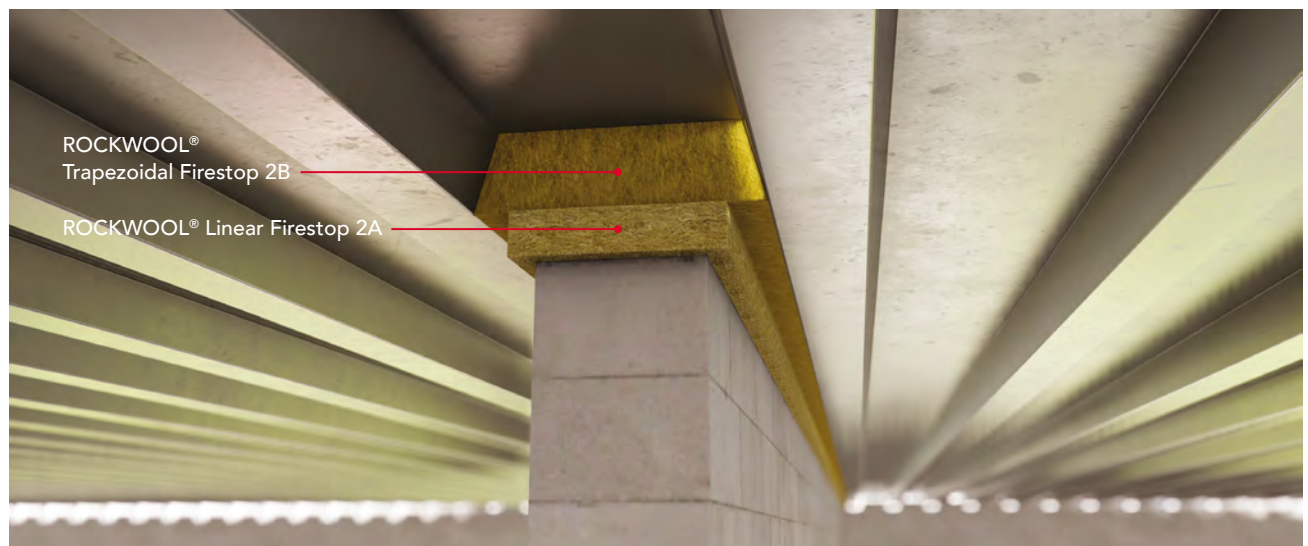



FirePro® Pipe Collar CE

FirePro® CE Pipe Collars are tested in accordance with BS EN 1366-3: 2009 to provide up to EI120* in walls and EI240* in rigid floors.

They are designed to seal service penetrations in apertures in walls and floors containing plastic pipes.

Benefits:

- Easy fixing method using common fixings
- Tested in rigid/flexible walls and rigid floors
- Up to 4 hours* fire resistance

*Subject to the application.

Product Code	Fire Rating (Hours)	Nominal O/D (mm)	MOQ (Box)	List Price/ Each
294131	2	40	1	€23.83
294136	2	55	1	€28.65
294137	2	63	1	€29.79
294138	2	75	1	€41.68
294139	2	82	1	€43.16
294140	2	90	1	€51.10
294142	2	110	1	€59.89
294143	2	125	1	€79.61
294145	2	160	1	€141.69
294147	2	200	1	€207.13
294149	2	250	1	€561.79



The ROCKWOOL Fire Stopping products are dispatched via a courier and not shipped as part of full or mixed loads, as such these products may incur a carriage charge. For further details please contact ROCKWOOL Customer Support Centre.

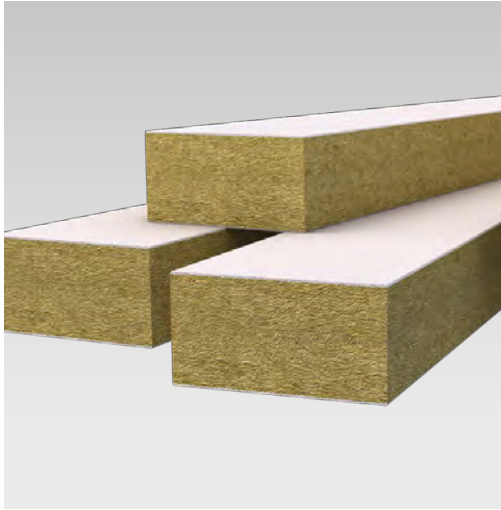

FirePro® SoftSeal System

FirePro® SoftSeal provides a firestopping solution for applications where high levels of movement in the building's services or joints need to be accommodated.

SoftSeal Linear Joint Seal is specifically designed to form a linear joint seal within buildings, where the design needs to accommodate movement in the joint. The product is only coated on one side.

Benefits:

- Acoustically absorbent
- Up to 2 hours* fire protection
- UL EU Certified
- Both vertical and horizontal joint applications

**Subject to the application.*

FirePro® SoftSeal

Product Code	Additional Information	Thickness (mm)	Width (mm)	Length (mm)	Pieces/Pallet	Area/Pallet (m ²)	Made to Order	MOQ (Pallet)	List Price Per Piece
289903	Linear Joint Seal - Coated 1 Side	100	200	1200	72	17.28	•	1	€57.30
289908	Coated Strip - Coated 2 Sides	100	200	1200	72	17.28	•	1	€62.31

FirePro® SoftSeal Ancillaries

Product Code	Additional Information	Pack Size	Pack	Made to Order	MOQ	Unit List Price
190377	Flexible Coating	5L	Tub		1 Tub	€215.54/Tub



Be in the know on passive **fire protection**



Our latest fire CPDs will help you advise on product choices and applications with confidence:

Fire Stopping: Understanding your liability

This CPD will provide insight into how you can fulfil your legal responsibilities through improved knowledge and adopting best practices.

A to Z of Essential Principles

The A to Z of Essential Principles are of vital importance and should be considered in detail by building designers, fire engineers, consultants, occupiers or building owners.

Passive Fire Protection for Structural Steel

This CPD focuses on providing an understanding of the key considerations for insulating structural steel members, and how choosing the right insulation solutions can extend fire protection periods and simplify compliance.

Book your free sessions now at www.rockwool.com/uk/cpd



HVAC Products

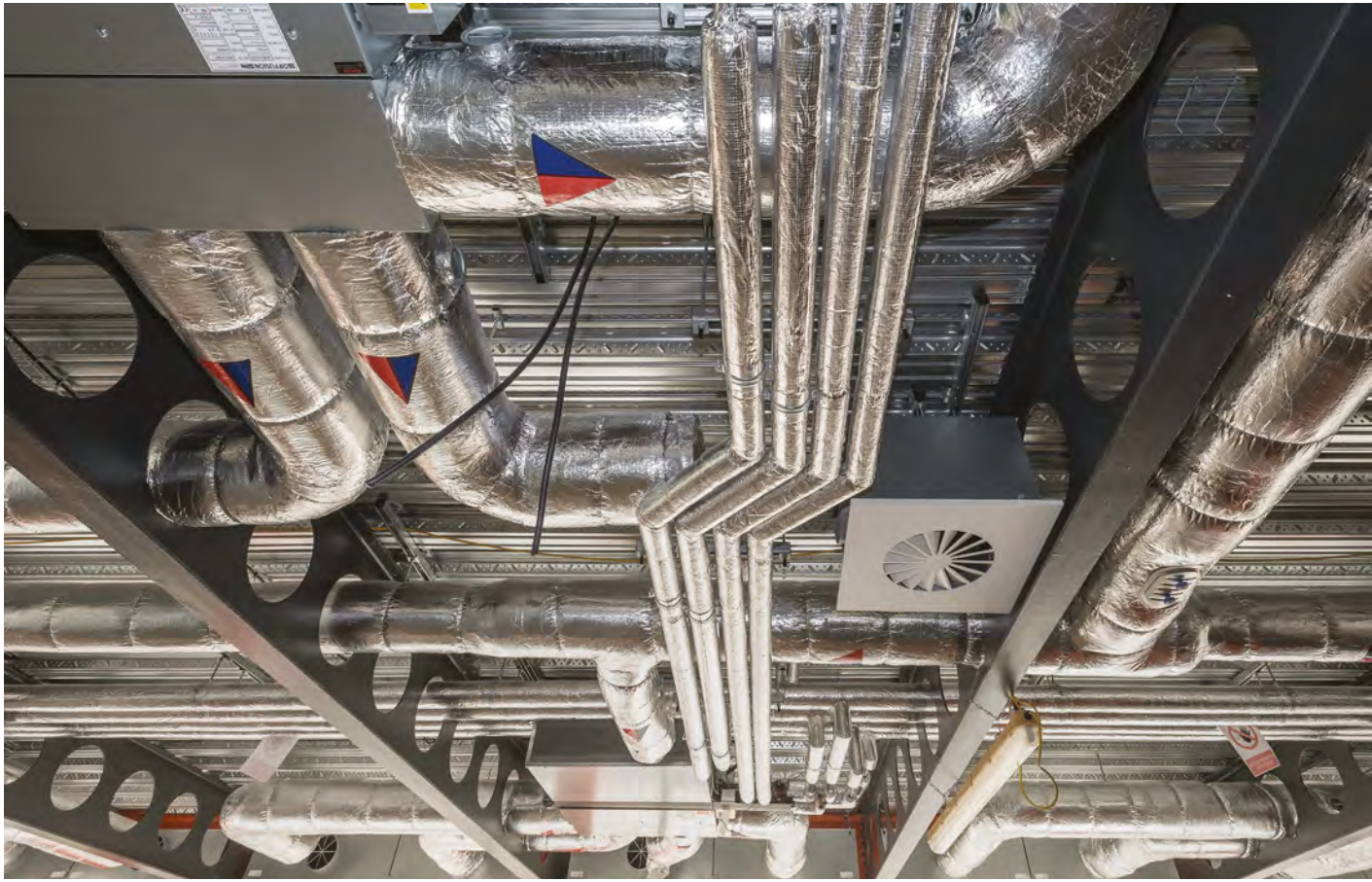

Heating Ventilation and Air conditioning (HVAC) systems form an integral part of modern environments, both commercial and domestic - particularly where high rise and large scale developments are concerned.

ROCKWOOL non-combustible stone wool products for HVAC applications can be used to control heat gain, minimise heat loss and reduce noise. In addition, certain products can deliver a fire resistance rating both into, and out of, the HVAC system.

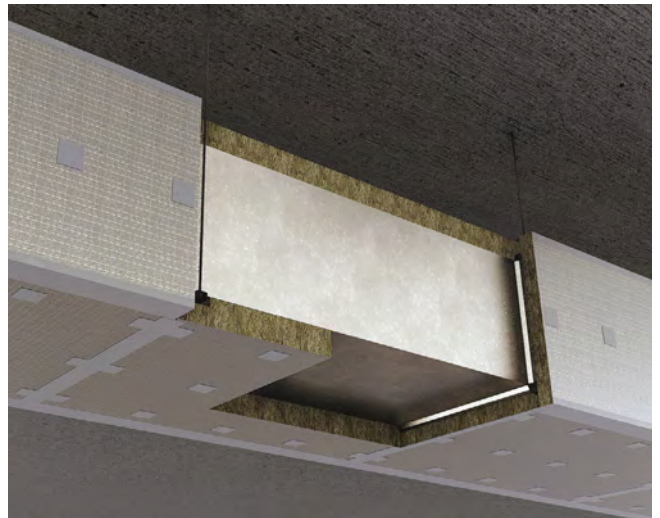

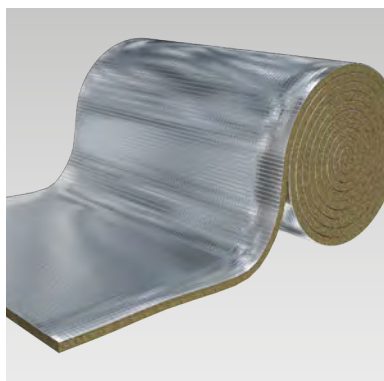

Ductslab and Ductwrap

Ductslab and Ductwrap provide thermal insulation for air conditioning, warm air and extractor ducts, located either in plant rooms and boiler houses or externally. They can also be used to thermally insulate cold water storage tanks, feeds and expansion tanks with service temperatures of up to 230°C.

Ductwrap consists of a lightweight, flexible insulation roll faced with reinforced aluminium foil. Ductslab consists of a semi-rigid insulation slab faced with reinforced aluminium foil.

Benefits:

- CE marked to EN14303
- Non-combustible (Euroclass A1)
- Water repellent
- Chemically inert
- Easy to handle and install

*Alternative thicknesses can be made to order.
For details please contact your local ROCKWOOL representative.*

Pallet size 1200 x 1200mm

Product Code	Additional Information	Thickness (mm)	Width (mm)	Length (mm)	Pieces/ Pack	Area/ Pack (m ²)	Packs/ Pallet	Area/ Pallet (m ²)	List Price/m ²
122929	Slab	40	600	1000	10	6.00	15	90.00	€20.12
122930	Slab	50	600	1000	8	4.80	15	72.00	€23.86
122931	Wrap	25	1000	5000	2	10.00	21	210.00	€16.04
122932	Wrap	40	1000	4000	2	8.00	21	168.00	€20.55
122933	Wrap	50	1000	6000	1	6.00	21	126.00	€23.71

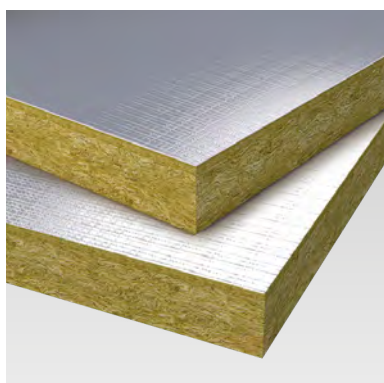

DuoDuct External Ductslab

DuoDuct is a Dual-Density stone wool slab with an aluminium foil facing bonded to the outer surface. The robust outer layer provides enhanced impact resistance and a suitable substrate for surface applications such as cladding.

Designed for use on rectangular or square external ductwork, ROCKWOOL DuoDuct is suitable for insulating cold air, hot air and dual-purpose duct systems – withstanding service temperatures of up to 230°C.

Benefits:

- Rated Euroclass A1 non-combustible
- Suitable for use with self-adhered external duct membranes
- For increased efficiency, the slabs are designed to be easy to cut and install
- ROCKWOOL Dual-Density technology provides enhanced impact resistance, ideal for areas susceptible to damage
- Sound absorbent qualities to reduce environmental noise

*Alternative thicknesses can be made to order.
For details please contact your local ROCKWOOL representative.*

Pallet size 2000 x 1200mm

Product Code	Additional Information	Thickness (mm)	Width (mm)	Length (mm)	Pieces/Pallet	Area/ Pallet (m ²)	MOQ (Pallet)	List Price/m ²
263218	Foil faced	50	1200	2000	24	57.60	1	€26.51

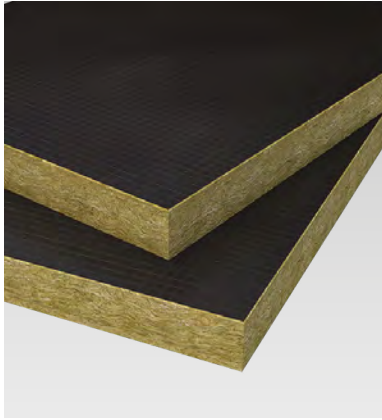

FirePro® DuctRock® Slab

Tested to BS EN 1366:Part 1 and BS EN 1366:Part 8, FirePro® DuctRock® Slab is capable of providing up to 2 hours* fire ratings on both ventilation and smoke extract ducts. The new high emissivity black foil provides a great aesthetic finish and clearly identifies the product as the latest EN tested solution. Quick to install and easy to handle, FirePro® DuctRock® Slab achieves fire ratings ranging from EI30 to EI120 with only 3 thicknesses.

Benefits:

- Up to 2 hours* fire rating in accordance with EN 1366:Part 1 and EN 1366:Part 8
- Black foil finish
- Suitable with many duct types
- Patented dry wall penetration detail
- Quick and easy to install

*Subject to the application.

Pallet Size 2000 x 1200mm

Product Code	Additional Information	Thickness (mm)	Width (mm)	Length (mm)	Pieces/Pallet	Area/Pallet (m ²)	Made to Order	MOQ (Pallet)	List Price/m ²
262503	Black foil facing	60	1000	1200	42	50.40			€132.87
262505	Black foil facing	80	1000	1200	32	38.40	•	8	€218.06
262507	Black foil facing	90	1000	1200	24	28.80			€245.48

Product Code	Additional Information	Thickness (mm)	Width (mm)	Length (m)	Rolls/Box	MOQ (Box)	List Price/Roll
259345	Black ALU foil tape	N/A	75	50	16	1	€59.27

Product Code	Additional Information	Thickness (mm)	Width (mm)	Length (mm)	Pieces/Pack	MOQ (Pack)	List Price/Pack
273113	Steel U-Profile	1.5	60	1500	4	1	€112.98

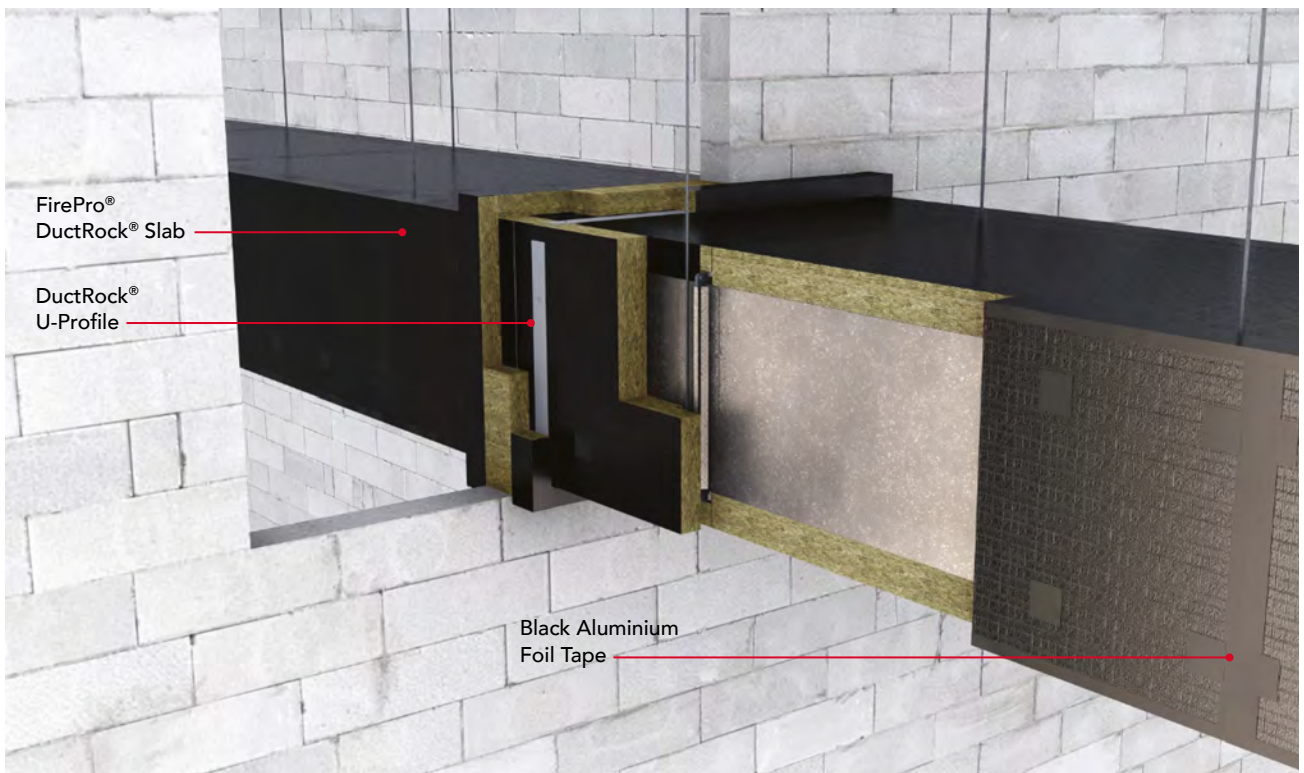

Achieve CO² savings with BS 5422:2023

The Guide to BS 5422:2023 clarifies recent changes to the technical document for thermal insulation of building services.

Download the comprehensive ROCKWOOL handbook to BS 5422:2023 featuring:

- An accessible changelog
- Updated thickness tables per application
- Insulation best practice
- Recommended ROCKWOOL solutions

Start specifying today and ensure best practice for building services insulation.



Download the guide:



rockwool.com/uk/building-services-hvac-hub



X in f o y
rockwool.com/uk

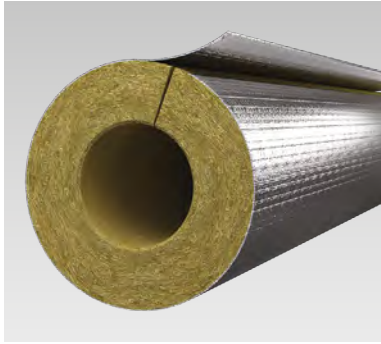

RockLap H&V Pipe Sections

RockLap H&V Pipe Sections are strong lengths of pre-formed insulation with a one piece, factory applied foil facing with integral self-adhesive lap. The integral lap ensures fast and easy installation: just snap the sections onto the pipe, peel off the backing tape and smooth down for a completely sealed joint.

Please contact ROCKWOOL Customer Support Centre for further information. Alternatives Sizes may be available. For further details please contact your ROCKWOOL Sales Representative. These products are POA, subject to availability and MOQ at the time of enquiry.

ALL PRODUCTS LISTED ARE MADE TO ORDER.

To Suit Pipe O/D per mm	List Price/linear metre by thickness														
	20mm			25mm			30mm			35mm			40mm		
	Product Code	List Price		Product Code	List Price		Product Code	List Price		Product Code	List Price		Product Code	List Price	
17	225617	€8.45	42	225619	€9.39	30	225620	€12.28	25	125367	€23.45	20	125390	€17.40	16
21	225621	€8.87	36	225622	€9.90	30	225625	€13.06	20	125368	€16.14	13	125391	€16.49	13
27	225626	€9.38	30	225628	€11.21	25	225629	€14.02	20	125369	€16.28	12	212907	€18.63	12
34	125217	€10.24	25	125324	€11.85	20	125357	€14.67	16	125370	€16.75	12	125393	€18.68	9
42	125225	€11.51	20	125326	€13.01	16	125358	€16.04	12	125373	€18.28	9	125394	€19.79	9
48	125308	€12.28	16	125339	€14.02	16	125359	€16.99	12	125375	€18.90	9	125395	€20.79	9
54	125318	€13.25	16	125340	€15.09	12	125360	€18.42	10	125376	€20.57	8	125396	€22.59	8
60	125319	€14.04	12	125341	€16.04	12	125361	€19.62	9	125383	€21.61	7	125397	€24.05	7
67				125342	€23.81	9	125362	€24.81	9	125384	€28.75	6	125398	€29.64	6
76				125344	€24.23	9	125363	€25.91	7	125385	€29.56	5	125399	€30.14	5
80				125345	€25.20	9	125365	€39.99	6	125386	€43.38	5	125400	€45.13	5
89				125346	€26.26	6	125366	€27.98	6	125388	€33.19	4	125406	€32.77	4
102				125347	€41.57	5	123482	€27.17	■	123511	€42.80	■	123535	€35.54	■
108				125348	€28.86	5	123483	€30.53	■	123512	€44.79	■	123536	€36.69	■
114				125349	€30.28	4	123484	€32.27	■	123513	€35.21	■	123537	€37.60	■
127				125353	€45.87	4	123485	€45.60	■	157893	€48.61	■	123538	€58.03	■
133				123458	€43.86	■	123486	€46.04	■	123514	€56.10	■	123539	€43.38	■
140				123459	€31.14	■	123487	€36.39	■	123515	€56.82	■	123540	€42.88	■
150				209369	€134.40	■	209370	€138.71	■	209371	€144.05	■	209372	€146.56	■
154				209378	€126.23	■	209379	€128.42	■	209380	€144.39	■	209381	€133.02	■
159				123460	€56.49	■	123488	€41.91	■	123516	€61.54	■	123541	€47.77	■
169				123461	€39.37	■	123489	€42.88	■	123517	€47.44	■	123542	€50.15	■
178				209396	€57.88	■	209397	€60.57	■	209398	€63.36	■	209399	€74.46	■
191				209404	€58.78	■	209405	€65.53	■	209406	€68.40	■	209407	€75.75	■
194				123462	€59.04	■	123490	€65.81	■	209412	€68.72	■	123543	€76.22	■
205				123463	€63.81	■	123491	€66.76	■	123518	€79.28	■	123544	€82.49	■
219				123464	€48.71	■	123492	€55.48	■	123519	€60.92	■	123545	€62.86	■
230													123546	€162.17	■
245				123465	€154.63	■	209436	€157.18	■	123520	€160.40	■	123547	€173.05	■
253				123466	€154.57	■	123493	€167.19	■	209446	€170.48	■	123548	€173.72	■
273				123467	€165.32	■	123494	€119.62	■	123521	€172.20	■	123549	€127.12	■
279				209454	€165.78	■	209455	€169.22	■	209456	€172.75	■	209457	€190.26	■
305				123468	€181.42	■	123495	€184.92	■	123522	€188.72	■	123550	€192.54	■
318				209474	€182.32	■	209475	€186.22	■	209476	€190.11	■	123551	€194.11	■
324				123469	€121.43	■	123496	€186.58	■	209487	€190.65	■	123552	€194.59	■
356							123497	€189.12	■	209490	€193.51	■	123553	€205.39	■
406							123498	€181.43	■	209495	€186.09	■	123554	€210.42	■

Benefits:

- Fast and simple to install reducing costs and time on site
- Tape requirement reduced
- CE marked to EN14303

KEY: 42 Number indicates the Linear Metres per carton (supplied split).

■ These sections come "split" and are packed as single lengths which are shrink wrapped in polyethylene.

■ These sections come "unsplit" and are packed as single lengths which are shrink wrapped in polyethylene.

Length 1000mm

List Price/linear metre by thickness																			
50mm				60mm				70mm				80mm				100mm			
Product Code	List Price			Product Code	List Price			Product Code	List Price			Product Code	List Price			Product Code	List Price		
125419	€23.52	9																	
125420	€24.46	9																	
125421	€26.30	8					125435	€143.17	4										
125422	€27.47	6	125431	€50.78	4	125436	€60.64	4	123658	€60.66	■	209316	€81.70	■					
125423	€28.92	6	125432	€47.04	4	123631	€51.50	■	123659	€70.09	■	123692	€83.04	■					
125424	€30.84	5	125433	€58.37	4	123632	€60.21	■	209324	€71.13	■								
125425	€32.75	5	125434	€49.77	4	123633	€57.04	■	123660	€71.39	■	123693	€89.79	■					
125426	€34.70	4	123608	€57.88	■	123634	€62.22	■	209331	€69.14	■	209333	€98.00	■					
125427	€39.24	4	123609	€53.84	■	123635	€70.11	■	123661	€70.55	■	123694	€99.83	■					
125428	€57.48	4	209339	€59.68	■	123636	€71.83	■	129865	€78.44	■	209343	€102.32	■					
123581	€38.77	■	123610	€57.47	■	123637	€65.87	■	123662	€75.34	■	123695	€108.38	■					
123582	€51.26	■	123611	€71.68	■	209347	€77.41	■	173908	€84.79	■	123696	€114.46	■					
123583	€48.11	■	123612	€73.04	■	123638	€87.97	■	123663	€94.74	■	123697	€127.60	■					
123584	€48.98	■	123613	€68.44	■	123639	€81.94	■	123664	€93.66	■	123698	€125.07	■					
123585	€57.87	■	130831	€117.86	■	123640	€85.54	■	209358	€100.42	■								
123586	€70.89	■	209361	€78.10	■	209218	€92.92	■	209364	€104.42	■	209366	€196.70	■					
123587	€55.10	■	123614	€81.63	■	123641	€92.43	■	123665	€106.35	■	123699	€198.17	■					
209374	€153.49	■	209376	€162.13	■														
209383	€154.02	■	209385	€166.46	■	209387	€174.18	■	209389	€187.39	■								
123588	€61.57	■	123615	€78.16	■	123642	€102.68	■	123666	€116.07	■	209394	€202.23	■					
123589	€63.84	■	123616	€84.06	■	123643	€94.09	■	123667	€130.85	■	123700	€158.24	■					
193368	€164.70	■	209402	€98.97	■														
209409	€87.32	■	209411	€100.67	■														
123590	€87.70	■	209415	€101.45	■	209417	€187.09	■	123668	€194.33	■	209419	€213.38	■					
123591	€79.21	■	123617	€178.98	■	123644	€189.05	■	131322	€196.43	■	209424	€226.16	■					
123592	€80.23	■	123618	€128.47	■	123645	€135.66	■	123669	€143.78	■	123701	€172.01	■					
171608	€177.71	■	209429	€185.53	■	209431	€196.35	■	209433	€204.19	■	209435	€239.27	■					
123593	€166.20	■	209439	€191.14	■	209441	€198.68	■	209443	€217.12	■	209445	€242.41	■					
123594	€184.63	■	123619	€192.03	■	125298	€210.24	■	123670	€204.70	■	123702	€245.03	■					
123595	€128.43	■	123620	€134.15	■	123646	€146.79	■	123671	€163.30	■	123703	€248.77	■					
209459	€198.73	■	209461	€206.31	■	209463	€214.45	■	209465	€230.93	■	209467	€249.71	■					
123596	€200.65	■	123621	€209.98	■	209471	€226.34	■	123672	€235.55	■	123704	€282.00	■					
209478	€210.18	■	209480	€219.46	■	209482	€228.41	■	209484	€237.86	■	209486	€285.07	■					
123597	€145.03	■	123622	€160.25	■	123647	€228.99	■	123673	€265.97	■	123705	€209.67	■					
123598	€152.15	■	123623	€251.84	■	123648	€261.21	■	123674	€246.02	■	123706	€293.81	■					
123599	€175.30	■	123624	€258.35	■	123649	€269.18	■	123675	€253.71	■	123707	€331.25	■					

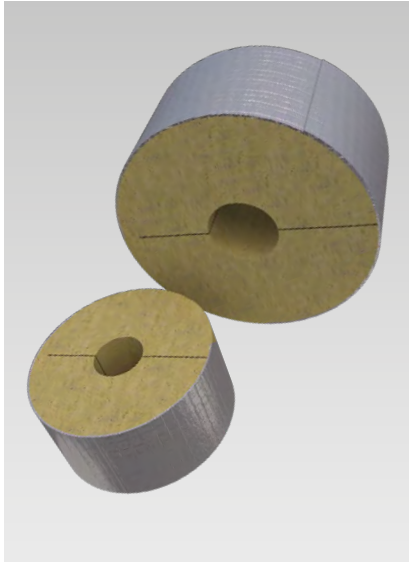

RockLap H&V Pipe Supports

RockLap Pipe Supports are designed to reduce the thermal bridge at the point at which the pipe hanger clips are located. Pre-formed and pre-cut into cylindrical sections with a foil facing finish to maintain an integral vapour barrier. RockLap Pipe Supports are simple to install with a self-adhesive overlap. Combined with RockLap H&V Pipe section insulation solutions they provide a total thermal solution for pipework with the additional benefits of fire safety and acoustic comfort.

Please contact ROCKWOOL Customer Support Centre for further information. Alternative sizes may be available. For further details please contact your ROCKWOOL Sales Representative.

ALL PRODUCTS LISTED ARE MADE TO ORDER.

Delivery terms are dependent upon order size:

- ≥40 cartons: Fixed delivery date, no surcharge.
- 15-39 cartons: €72 small order surcharge, fixed delivery date.
- Orders <15 cartons: €72 small order surcharge and subject to groupage within a 5 working day range (Mon - Fri).

To Suit Pipe O/D (mm)	Length (mm)	20mm			25mm			30mm		
		Product Code	Supports/Box	List Price/Box	Product Code	Supports/Box	List Price/Box	Product Code	Supports/Box	List Price/Box
17	80	287429	128	€678.94	287437	98	€556.18	290202	72	€438.62
21	80	287431	128	€700.57	287434	72	€422.39	290274	72	€454.85
27	80	287436	98	€556.18	287438	72	€426.46	287442	50	€328.99
34	80	287443	72	€461.60	287440	50	€344.02	290200	50	€368.41
42	80	294323	72	€492.69	287444	50	€368.41	290523	32	€303.45
48	80	306127	50	€345.90	290204	50	€511.11	298804	32	€331.68
54	80	298840	50	€348.71	290205	32	€331.68	290584	32	€347.92
60	80	306323	50	€375.01	290209	32	€341.90	294324	32	€370.14
67	80				290214	32	€350.33	301328	18	€242.97
76	80				290210	18	€207.14	299639	18	€250.05
89	80				290216	18	€252.44	300027	18	€298.05
108	80				290217	18	€336.59	293380	8	€173.99
114	80				290218	18	€367.33	300197	8	€186.63
140	80				TBC	8	€190.22	309994	8	€243.54
169	100				312499	8	€266.96	300024	8	€327.03

ROCK-EQ HVAC TOOL

$$q = \left(\frac{\theta_{si} - \theta_{se}}{R} \right) h_{cv} = 5,76 \times$$

$$\Delta U_B = U \left[\sum_{j=1}^n z_j + \sum_{j=1}^m z_j^* \right]$$

$$h_{cv} = 3,96 \times$$

$$R'_i = \frac{1}{2\pi} \sum_{j=1}^n \left(\frac{1}{\lambda_j} \right)$$

Benefits:

- Non-combustible stone wool
- Energy efficient - minimising thermal bridging
- Robust foil facing to maintain a vapour control
- High point load resistance and effective load bearing capability
- A total insulation solution when combined with RockLap H&V pipe sections



Orders for RockLap H&V Pipe Supports cannot be used to contribute towards mixed loads. The lead times for these products can vary and will be confirmed on receipt of order.

Pallet Size 1200mm x 1000mm

	To Suit Pipe O/D (mm)	Length (mm)	35mm			40mm			50mm		
			Product Code	Supports/Box	List Price/Box	Product Code	Supports/Box	List Price/Box	Product Code	Supports/Box	List Price/Box
	17	80	315475	50	€369.79	295606	50	€423.81	299927	32	€364.75
	21	80	312932	50	€439.20	287795	32	€280.62	299928	32	€374.35
	27	80	309866	50	€453.64	287794	32	€287.83	299929	18	€217.29
	34	80	300833	32	€340.06	287409	32	€322.09	300174	18	€239.94
	42	80	302746	32	€373.53	287412	32	€374.35	289092	18	€278.12
	48	80	309870	32	€383.34	287414	18	€207.14	TBC	18	€266.31
	54	80	312933	32	€378.72	290525	18	€214.92	294561	18	€274.07
	60	80	309871	18	€228.19	287417	18	€228.43	298725	18	€290.97
	67	80	TBC	18	€272.33	290527	18	€286.90	290526	8	€166.18
	76	80	312934	18	€282.07	287426	18	€293.32	TBC	8	€174.73
	89	80	TBC	18	€307.71	287428	12	€231.16	290585	8	€193.96
	108	80	TBC	10	€216.97	305637	8	€194.26	304193	8	€239.02
	114	80	TBC	10	€230.49	287791	8	€206.14	301329	8	€253.45
	140	80	TBC	10	€301.90	287789	8	€269.04	309993	8	€326.00
	169	100	TBC	8	€343.32	304418	8	€362.48	329593	4	€433.35

Select the optimum thickness of building services and HVAC insulation quickly and easily with our online calculator, ROCK-EQ.

The online tool produces detailed, project-specific calculation reports and recommendations from the ROCKWOOL HVAC range in a matter of minutes.

Find it at:

www.rockwool.com/uk/resources-and-tools/tools/

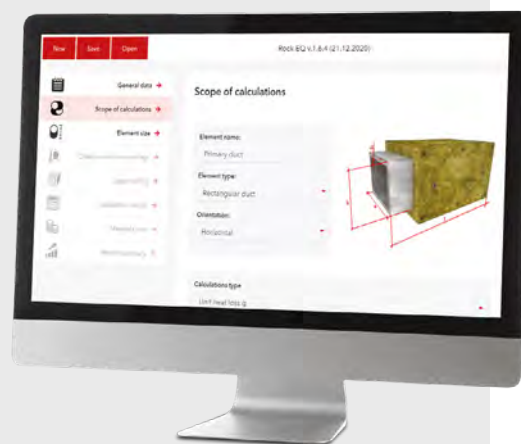

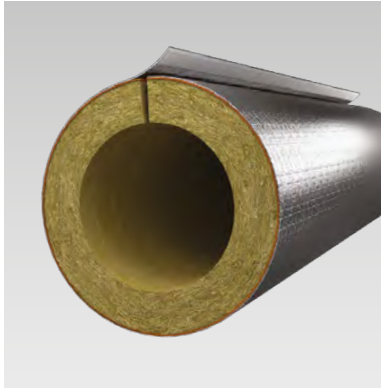

Techtube

Techtube is a laminate product comprising ROCKWOOL® Acoustic Membrane and reinforced aluminium foil. Engineered to provide the highest standard of noise control to circular ductwork, rainwater, soil-vent, and service pipes.

Benefits:

- Superior acoustic performance maintained by preserving thickness at corners, bends and fixing locations
- Single application of materials
- Easy to handle and install
- Excellent thermal insulation properties

5kg/m² Polymeric

Nominal O/D per mm	List Price/linear metre by thickness							
	Product Code	25mm Price	Product Code	30mm Price	Product Code	40mm Price	Product Code	50mm Price
114	124981	€154.50	124990	€170.57	253586	€194.76	251412	€230.57
127	268966	€167.04	TBC	€183.58	253589	€208.41	TBC	€244.76
159	189883	€189.96	TBC	€206.46	TBC	€231.22	254284	€268.75
169	251545	€199.95	265692	€217.09	125013	€243.12	251415	€280.50
219	279184	€251.33	124995	€270.10	TBC	€313.93	TBC	€363.55
324			TBC	€371.13	TBC	€404.51	125029	€453.33

Alternative sizes can be made to order. For details please contact ROCKWOOL Customer Support Centre.

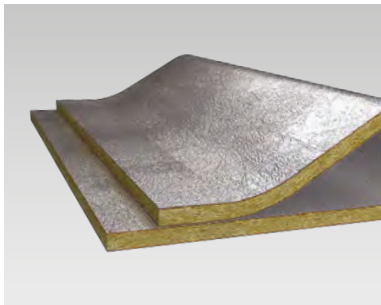

Techwrap2

Made of ROCKWOOL stone wool insulation, acoustic membrane and a layer of reinforced aluminium foil, Techwrap2 is designed to enhance noise control to rectangular ductwork.

Techwrap2 has been independently tested at the Acoustical Investigation & Research Organisation (AIRO).

5kg/m² Polymeric. Pallet size 1200 x 1000mm

Product Code	Additional Information	Thickness (mm)	Width (mm)	Length (mm)	Pieces/Pallet	Made to Order	MOQ (Pallet)	List Price/m ²
251264	Foil faced	25	1000	1200	40	•	1	€158.45
251431	Foil faced	50	1000	1200	20	•	1	€182.18



Alternative sizes can be made to order. For details please contact ROCKWOOL Customer Support Centre.
Techwrap2 orders cannot be used to contribute towards mixed loads.
The lead times for these products can vary and will be confirmed on receipt of order.
Additional carriage charges may apply, please contact Customer Services for information.

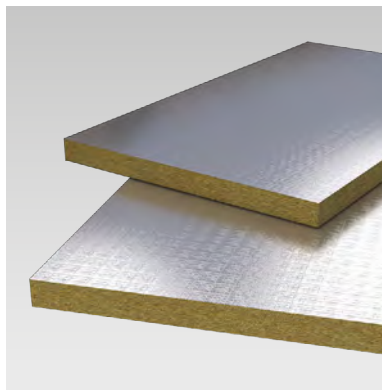

Fire Duct Slab

Fire Duct Slab is designed for use within a square or rectangular third-party tested fire-rated ductwork system.

Please contact a third-party system holder for performance, certification and installation details.

Pallet Size 2000 x 1200mm

Product Code	Thickness (mm)	Width (mm)	Length (mm)	Pieces/Pallet	Area/Pallet (m ²)	Made to Order	MOQ (Pallet)	List Price/m ²
123087	40	1200	2000	30	72.00			€102.85
252867	50	1200	2000	24	57.60	•	6	€123.38
123090	90	1200	2000	12	28.80			€238.33

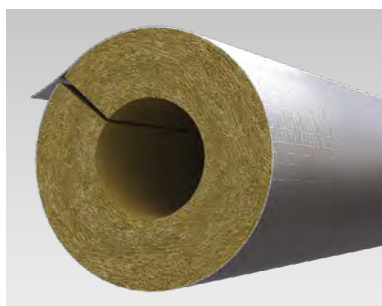

Fire Duct Section

Fire Duct Section is designed for use within a circular third-party tested fire-rated ductwork system. The product is available to suit outer diameters between 17mm and 610mm.

Please contact a third-party system holder for performance, certification and installation details.

Length 1000mm

Nominal O/D (mm)	40mm Fire Duct Section		90mm Fire Duct Section		Made to Order
	Product Code	Price List	Product Code	Price List	
17	254102	€48.82	-	-	•
76	266785	€80.49	261509	€237.80	•
102	259314	€103.06	253665	€279.90	•
108	257770	€108.08	257281	€287.15	•
114	258004	€109.13	123068	€303.10	•
127	123045	€116.97	253663	€318.70	•
140	253292	€131.42	257284	€334.27	•
159	251597	€137.48	123071	€359.42	•
169	253294	€146.53	123072	€372.75	•
194	123049	€170.06	282953	€412.33	•
205	242421	€177.34	253585	€429.50	•
219	123051	€185.14	251817	€447.27	•
253	255279	€206.60	123077	€490.43	•
305	251626	€239.61	123079	€556.45	•
318	271363	€247.77	123080	€575.79	•
356	251871	€278.40	123082	€632.34	•
406	255113	€318.28	260102	€706.73	•

Alternative thicknesses can be made to order. For details please contact ROCKWOOL Customer Support Centre.

The packaging and splitting of these items varies according to the size of the section. These sections, will be supplied either pre-split or unsplit depending on the size required. Some sizes are boxed and some are supplied as singles wrapped in polythene. For details on the specific packaging and splitting of the pipe required, please refer to the RockLap packing specification on pages 64 and 65 or contact the ROCKWOOL Customer Support Centre.

Fire Duct Slab and Fire Duct Section should be specified and installed in accordance with the duct manufacturers fire testing and certification.

Please note that as per our September 2022 communication regarding Fire Duct and legacy BS standards, Fire Duct is no longer covered by ROCKWOOL-tested certification. Where this impacts ongoing projects, advice should be sought from the ASFP via info@asfp.org.uk

LEGAL NOTICES**General safety requirements – Building Safety Act 2022**

ROCKWOOL Limited is committed to supporting specifiers, resellers and users of ROCKWOOL products for the full life cycle of the product to comply with the obligations and responsibilities set out in the Building Safety Act 2022. With regard to the general safety requirements of the Act, ROCKWOOL Limited cannot control or foresee every situation where its products might be used. We therefore strongly advise that specifiers, resellers and users contact us where use of ROCKWOOL products is contemplated in applications different from those explicitly described in the latest, relevant ROCKWOOL product datasheets; especially in applications that can be reasonably foreseen as critical to safety.

ROCKWOOL Limited reserves the right to amend the specification of its products without notice. Changes to the ROCKWOOL manufacturing process, or to pertinent regulations, may be reflected in changes to tested and certified product performance. Whilst ROCKWOOL Limited endeavours to keep its publications up to date, readers will appreciate that between publications there may be pertinent changes in the law or other developments affecting the accuracy of the information contained in our publications.

ROCKWOOL Limited does not accept responsibility for the consequences of using (including testing or certifying) its products in applications different from those explicitly described in the relevant ROCKWOOL product datasheets. Expert advice should be sought, and ROCKWOOL Limited should be contacted, where such different use is contemplated, or where the extent of any use described by ROCKWOOL Limited is in doubt.

The ROCKWOOL Trademark

ROCKWOOL® - our trademark

The ROCKWOOL trademark was initially registered in Denmark as a logo mark back in 1936. In 1937, it was accompanied with a word mark registration; a registration which is now extended to more than 60 countries around the world.

The ROCKWOOL trademark is one of the most important assets of the ROCKWOOL Group, and is therefore well-protected and defended by ROCKWOOL throughout the world.

If you require permission to use the ROCKWOOL logo for your business, advertising or promotion, you must apply for a Trade Mark Usage Agreement.

To apply, write to:
marketcom@rockwool.com

Trademarks

Registered trademarks of the ROCKWOOL Group include but are not limited to:

ROCKWOOL®, RockClose®, RainScreen Duo Slab®, HardRock®, RockFloor® Flexi®, RockFall®, FirePro®, DuctRock®, BeamClad®, NyRock®

© ROCKWOOL 2024.
All rights reserved.

Photography and illustrations

The product illustrations are the property of ROCKWOOL Limited and have been created for indicative purposes only.

Unless indicated below, the photography and illustrations used in this guide are the property of ROCKWOOL Limited. We reserve all rights to the usage of these images.

If you require permission to use ROCKWOOL images, you must apply for a Usage Agreement.

To apply, write to:
marketcom@rockwool.com

HEALTH & SAFETY

A Material Safety Data Sheet is available and can be downloaded from www.rockwool.com/uk to assist in the preparation of risk assessments, as required by the Control of Substances Hazardous to Health Regulations (COSHH).

March 2024

ROCKWOOL Limited

Pencoed
Bridgend
CF35 6NY

Tel: 00 44 1656 862 621

customersupportcentre@rockwool.com

www.rockwool.com/uk



Version 7.02 March 2024.

© ROCKWOOL 2024. All rights reserved.